



UNIVERSITY OF
AUCKLAND
Waipapa Taumata Rau
NEW ZEALAND

International
Prospectus 2024

No.1 university in New Zealand

Top 100 worldwide¹



No 1
in New Zealand for
graduate employability²



Top 10
Globally for
Sustainability³



Top 50
in the world
for 8 subjects⁴



Ko Waipapa Taumata Rau mātou, e mihi
nei, e karanga nei ki te mārea e hiahia
ana ki te kai i te mātauranga
Nau mai, haere mai, herea mai tōu waka
ki te whare whakairo o Tāne-nui-a-rangi

We are Waipapa Taumata Rau, we greet,
we call to the many who desire the
sustenance of knowledge.
Welcome, come forth and fasten to the
carved meeting house, Tāne-nui-a-rangi.

Cover attributions

1. *QS World University Rankings 2024*
2. *QS Graduate Employability Rankings 2022*
3. *QS Sustainability Rankings 2023*
4. *QS World University Rankings by Subject 2023*

Nau mai, haere mai

A warm welcome to Waipapa Taumata Rau – The University of Auckland, New Zealand’s highest-ranked university

We’re New Zealand’s leading university.* Our expert lecturers and researchers will challenge your thinking and empower you. Across a comprehensive range of subjects, we’ll help you to realise your full potential.

Our superb reputation is carried around the world by thousands graduates who leave us each year with globally recognised qualifications. They’re highly employable. And they shine in their workplaces.** The excitement of graduate employment could begin for you here. For those who wish to stay on for work experience, New Zealand offers generous Post-Study Work Rights.

Whether for study or work, New Zealand has been named the second safest country in the World by the 2022 Global Peace Index. There’s no lack of energy though. Multicultural Auckland is alive with opportunities, urban conveniences and entertainment. All that,

and yet you’re never far from beautiful natural surroundings.

Our campuses offer those too, but our commitment to the environment goes much wider. The University also has a long-standing commitment to global sustainability through rigorous and creative research. This makes us an ideal choice if you share our wish to make a meaningful impact.***

We welcome over 8,000 international students from more than 100 countries each year. We celebrate diversity, inclusion and equity. All our students can access wide-ranging support services to help them grow, thrive and feel at home.

I know that many students experience financial barriers to education. We offer a range of scholarships and funding support for eligible international students to make our programmes more accessible and affordable.

I invite you to explore your study options and the support available here. I look forward to welcoming you to our campuses.



DAWN FRESHWATER
Ihorangi | Vice-Chancellor
Waipapa Taumata Rau | University of Auckland

* Times Higher Education and QS World Rankings 2023

** QS Graduate Employability Rankings 2022

*** Times Higher Education Impact Rankings and QS Sustainability Rankings 2023

Contents

01 About our University

Start your story in Aotearoa New Zealand	4
Auckland, a great place to study and live	5
World-class education	6
Research, innovation and sustainability	7
Build your global career	8
Our campuses	9
A diverse, welcoming and supportive community	10

02 What can you study?

Arts	12
Business	14
Creative Arts and Industries	16
Education and Social Work	18
Engineering	20
Law	22
Medical and Health Sciences	24
Science	26
Global Studies	28
International opportunities	29
Pathways to undergraduate study	30
English Language Academy	31
PhD study	32

03 Application and support information

Scholarships and funding	33
Entry requirements	34
Accommodation	36
Student services and support	37
Essential information	40
International tuition fees	41
Dates to remember	42
How to apply and useful web addresses	43

Start your story in Aotearoa New Zealand

Aotearoa is New Zealand's Maori name. It means "Land of the Long White Cloud". A thousand years ago, cloud formations guided our ancestors here as they sought a new homeland. Let your dreams of study draw you here in the same way.

Quick facts

NZ Population: 5,151,600*

Largest city: Auckland - population 1,571,718*

Capital City: Wellington

Official languages: English, Māori, New Zealand Sign Language

Currency: New Zealand dollar

Exchange rates: US\$0.62, €0.57 (May 2023)

Climate: Daytime temperatures in Auckland range from an average of 24°C (75°F) in summer (December to March) to 16°C (60°F) in winter (June to August)

Warmest months: January, February

Coldest months: July, August

Government: Parliamentary democracy, member of the Commonwealth

*Statistics New Zealand, February 2023.



Why study in New Zealand?

Choosing the right university is the start of a life-changing journey. Begin yours here in beautiful Aotearoa New Zealand. If you want to stand out and succeed in your chosen field, look no further than the University of Auckland. We are New Zealand's largest, most comprehensive and highest-ranked university. We nurture bright students doing amazing things as they prepare to move forward and shape the world through their passion.

Embracing all peoples

We in New Zealand have long welcomed people from many different backgrounds. New Zealanders, or Kiwis, are friendly and hospitable, with a relaxed and open-minded approach to life, which includes respecting individuals' rights, beliefs and choices. Auckland is a super-diverse city, and this is reflected in the friendly, multicultural student community at the University of Auckland.

Safe and secure

New Zealand is recognised as one of the safest countries in the world. You can feel secure and confident while you reside in student accommodation, attend to your studies and explore our beautiful country.

Post-study work opportunities

New Zealand has a progressive and generous work-rights policy. Eligible international students who wish to gain relevant work experience and transferable skills may be able to work here for up to three years on a post-study work visa after graduating.

A high standard of living

New Zealand has a desirable standard of living, with the quality of education, healthcare, transport, infrastructure and government services all above international averages. Our democracy is economically strong and politically stable, and our transparent system of law and government protects the rights of citizens and visitors.



Auckland, a great place to study and live

Our main campus sits in the heart of New Zealand's largest, most culturally vibrant and economically significant city. International students can tap into Auckland's energy and opportunity to gain a unique experience.

Excitingly multicultural

One in three Auckland residents is born overseas. Auckland is quintessentially Kiwi but also global in its atmosphere and outlook. More than 180 different cultural groups from around the world have made their home in Auckland. Its architecture, open spaces, meeting places, music, art, and events reflect this rich cultural mix. You'll find many active ex-pat communities providing opportunities to meet, socialise and worship with others from your homeland.

Top 10 Most Liveable City in the World**

Auckland ranks No. 10 out of 173 cities in the world for liveability. Its strong performance across five broad categories - stability, healthcare, culture and environment, education and infrastructure - makes it an ideal destination for your international student experience.

A city of opportunity

Auckland is a place where early adopters and forward thinkers can experiment with new businesses and ideas. Let your creative spirit take hold. Feel safe to explore new ways of thinking in a city that embraces innovation and ingenuity. Career opportunities abound. Auckland is home to a great variety of employers, including many of New Zealand's larger-scale organisations.

Immerse yourself in Māori and Pacific culture

From a traditional Māori pōwhiri (welcome) to festivals, ceremonies and language immersion, you can engage with Māori and Pacific culture in daily life. These are unique opportunities that can broaden your perspective beyond the classroom.

**Statistics New Zealand 2018*

***Economist Intelligence Unit (EIU) Global Liveability Index 2023*

Surrounded by nature

Auckland's natural environment seamlessly blends with urban life - from picturesque mountains, harbours and expansive urban greenery to breathtaking local beaches, islands, forests and waterfalls - all within easy reach of the city.

Our City Campus is located within a conservation area with more than 400 trees, creating a beautiful natural environment for students to enjoy.

**Auckland
is NZ's most
culturally
diverse city**

There are 180 ethnicities in
Auckland City*



World-class education

The University of Auckland is New Zealand's pre-eminent research-led institution. We have been recognised by international organisations for excellence in our teaching, research and sustainability work.



**No.1
university**
*in New Zealand
and 68th
worldwide¹*



**Top 10 in
the world**
for Sustainability⁴



**33% of the
top-rated
researchers in
the country**
*New Zealand's largest
research organisation*



No.1
*In New Zealand and
Top 100
worldwide for
graduate
employability²*

**Top 50
in the world**
for 8 subjects⁵



<i>Sports-related subjects</i>	<i>32</i>
<i>Education</i>	<i>37</i>
<i>Pharmacy & Pharmacology</i>	<i>37</i>
<i>Geography</i>	<i>43</i>
<i>Civil and Structural Engineering</i>	<i>45</i>
<i>Archaeology</i>	<i>46</i>
<i>Anthropology</i>	<i>47</i>
<i>English Language and Literature</i>	<i>47</i>



**Most
innovative**
*university in
New Zealand³*

**120+
undergraduate
subjects**
*across 8 faculties.
New Zealand's most
comprehensive university*



**8,000+
international students
from 100+
different
countries**

1. QS World University Rankings 2024

2. QS Graduate Employability Rankings 2022

3. Asia-Pacific Triple E Entrepreneurship and Engagement Excellence Awards in Higher Education 2020

4. QS Sustainability Rankings 2023

5. QS World University Rankings by Subject 2023

Research, innovation and sustainability

As New Zealand's leading research university¹, we foster trans-disciplinary research that significantly impacts the world. We are investing more each year to provide our researchers with the facilities, technology and support they need to make this happen.

Global, impactful and future-focused research

Researchers at the University of Auckland collaborate with their peers worldwide to accelerate research into some of the world's most compelling issues and future trends – scientific, environmental and social. Even if not directly engaged in this research, all our students benefit from the global perspectives gained and the opportunity to make a positive difference in the world.

World Top 12 for social impact

The University of Auckland has maintained a top place (12th) in the Global Times Higher Education Impact Rankings 2023. It held the top global spot in the first two years of the ranking. Our strong position reflects our commitment to our Sustainability Strategy and Net Zero Carbon Strategy. These initiatives support the drive for universities worldwide to meet the United Nations Sustainable Development Goals.²

In 2020, the University was appointed the official Hub for Sustainable Development Goal 4: Quality Education by the United Nations Academic Impact. Hosting the Hub reaffirms our long-standing commitment to ensuring inclusive and equitable education and lifelong learning opportunities for all.

If you're looking for a university where you can pursue world-changing and world-sustaining ideas, the University of Auckland is the right choice.

auckland.ac.nz/sustainability

Research institutes and centres

The University supports the work of more than 60 research units, centres and institutes, including two internationally renowned Large Scale Research Institutes – the Liggins Institute and the Auckland Bioengineering Institute. We also host four of New Zealand's ten Centres of Research Excellence (CoREs), which promote world-class research that contributes to the nation's development. The University also hosts seven research centres pioneering research in brain disorders, climate and biodiversity, ageing, global health, wellbeing and housing.

Inspirational leading-edge thinking

Our academics are experts in their fields. Many are world-renowned researchers, innovators and business or community leaders shaping the future of policy and industry. They provide a challenging and rewarding academic experience incorporating the latest theoretical principles and practical approaches to teaching and research.

Innovation made real

The University of Auckland is New Zealand's most innovative university³ – and the most entrepreneurial university in the Asia-Pacific region.⁴ We are known for our inventive and impactful graduates, many of whom have become industry leaders and change-makers. The Business School's Centre for Innovation and Entrepreneurship offers free co-curricular learning opportunities for all students at the University. It offers entrepreneurship programmes, such as Velocity, and facilities like the award-winning maker space and innovation hub Unleash Space. These are open to all students.

cie.auckland.ac.nz

Commercialise your ideas with UniServices

UniServices is our commercialisation company, helping students and academics to grow their research portfolios through partnerships with government and industry. We help bring ideas to life through our expertise in intellectual property and commercialisation. This increases the social impact and value of research outputs at the University.

Our investment in new ventures through the \$40 million University of Auckland Inventors' Fund and our connection with the Centre for Innovation and Entrepreneurship enable us to champion entrepreneurial students and academics alike.

uniservices.co.nz

1. QS World University Rankings by Subject 2023

2. Times Higher Education Impact Rankings 2023

3. Asia-Pacific Triple E Entrepreneurship and Engagement Excellence Awards in Higher Education 2020

4. Reuters Top 75: Asia's Most Innovative Universities rankings 2019

You can study a range of undergraduate and postgraduate courses that will help deepen your understanding of the United Nations Sustainable Development Goals.



auckland.ac.nz/sustainability-courses

Build your global career

Study at New Zealand's highest-ranked university and obtain the skills and qualifications sought by global employers. Learn new ways of thinking and enhance your future career while gaining a world-class education.

Highly employable graduates, generous work rights

The University is ranked in the world's Top 100 for Graduate Employability*, producing graduates with the capabilities employers want. As a graduate of the University of Auckland, you may be eligible for a post-study work visa. This will allow you to work with a New Zealand company. If you have a partner, they may be able to apply for a work visa, and your children may be able to study as domestic students in New Zealand schools. The post-study work visa may be a pathway to staying permanently in New Zealand if you qualify for other work or residency pathways. Most university students can work up to 20 hours a week part-time and full-time during scheduled study breaks.

Go online for the most up-to-date information about visas.

immigration.govt.nz

*QS Graduate Employability Rankings, number one in NZ and 68th worldwide in 2022

Career support for every student at every step

Our Career Development and Employability Services (CDES) team has dedicated wrap-around support programmes, and practical resources available free to every student. We can assist you with all aspects of career development. We can help you navigate the world of work, life and study through national and international job opportunities, job search tools and resources, workshops, events and consultation. Our industry networking events and workplace advice will prepare you for your future job when you graduate. The popular Workplace Insights Programme pairs selected international students with alumni to enrich your understanding of the New Zealand workplace while building your confidence.

cdes.auckland.ac.nz

Connect with employers while you study

Through your faculties or selected courses, you'll have many opportunities for internships, work placements and exchanges with global companies in New Zealand and overseas. The connections you'll make could significantly boost your career potential.

Apply your knowledge in real industry settings

At the University of Auckland, you'll benefit from teaching and learning environments that reflect the world of work. Many of our faculties have simulation labs, studios and workspaces – fully equipped with the same technology, tools and equipment as real industry settings. Your hands-on learning will help you to tackle the world of work with confidence, especially in an increasingly digitised future.

A hotspot for entrepreneurs

The University of Auckland has created a fertile environment where entrepreneurs and start-ups can realise their vision. Initiatives such as Velocity, our flagship entrepreneurship programme, and Unleash Space, our innovation hub, allow students to combine business with research, bringing ideas to life and market. We will support you through the innovation and entrepreneurship life cycle: from concept generation and prototyping to product commercialisation.



“The help from CDES has really made me a lot more confident in myself and my abilities to network and seek opportunities. I have built up a wide array of tips, tricks, and tools from CDES which carry over into multiple aspects of my life. I have met many alumni in the field of economics, and I have a solid understanding of what it means to be successful as a graduate.”

Audrey Sears

Audrey Sears, from Virginia, USA, is studying the Bachelor of Arts, majoring in Economics and Politics and International Relations. She is preparing to start a graduate role in procurement based in Auckland.



Read more
[auckland.ac.nz/
meet-audrey](https://auckland.ac.nz/meet-audrey)

**Highest ranked
NZ university
for graduate
employability***



1

Tai Tokerau Campus

The Faculty of Education and Social Work offers courses at the Tai Tokerau Campus in Whangarei, the largest city in the Northland Region.

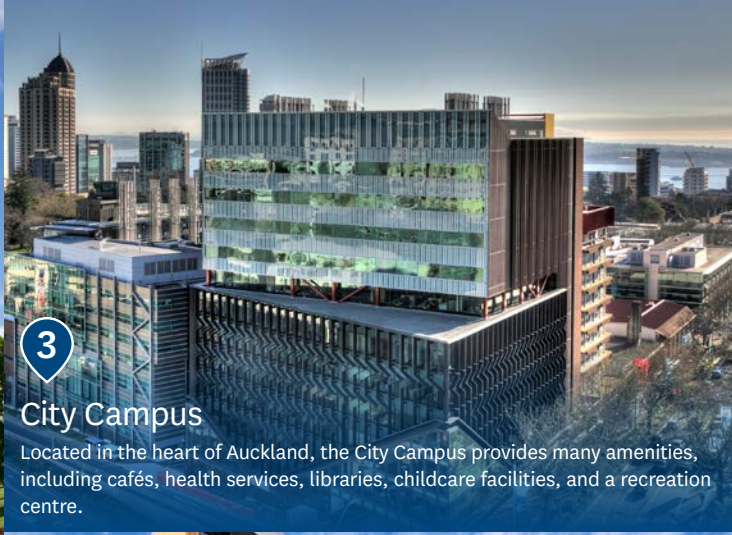

3

City Campus

Located in the heart of Auckland, the City Campus provides many amenities, including cafés, health services, libraries, childcare facilities, and a recreation centre.



6

Grafton Campus

Home to the Faculty of Medical and Health Sciences, the Grafton Campus is situated opposite Auckland City Hospital.



2

Goldie Estate Wine Science Centre

This 14-hectare vineyard and winery on Waiheke Island provide a unique venue where Wine Science students live, study and work in a boutique winery in a vital winegrowing region.



4

Newmarket Campus

This five-hectare campus houses state-of-the-art equipment, laboratories and structures designed to support research activities for the faculties of Engineering and Science.



5

Leigh Marine Laboratory

The Leigh Marine Laboratory is the University's "marine campus", offering postgraduate study and research opportunities at the Goat Island Marine Reserve, New Zealand's first marine reserve, established in 1975.

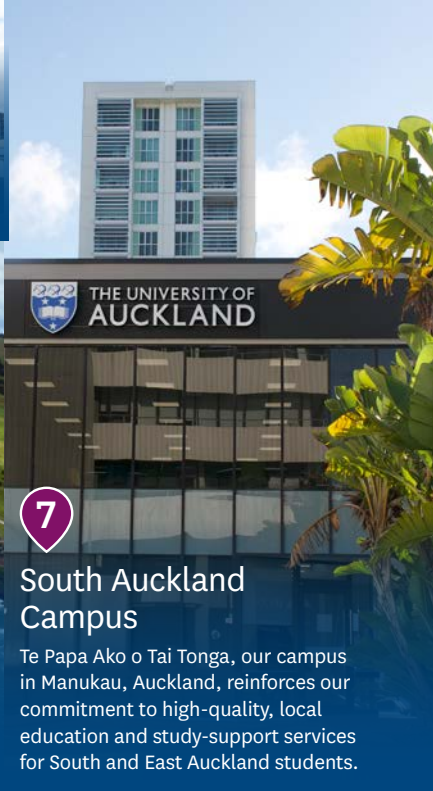

7

South Auckland Campus

Te Papa Ako o Tai Tonga, our campus in Manukau, Auckland, reinforces our commitment to high-quality, local education and study-support services for South and East Auckland students.



Our 7 campuses



auckland.ac.nz/campuses

A diverse, welcoming and supportive community

The University of Auckland welcomes over 8,000 international students from more than 100 countries annually. Our friendly and supportive multicultural community will help make you feel at home.

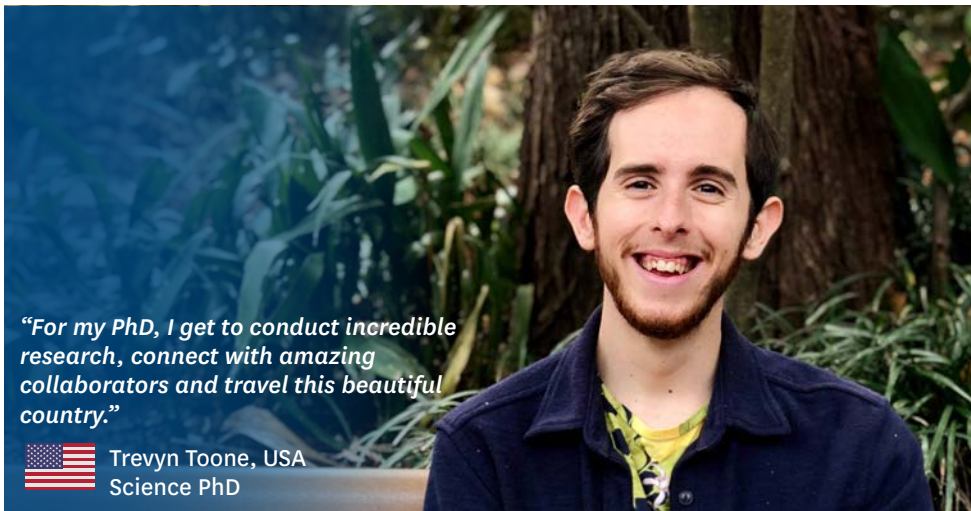

"For my PhD, I get to conduct incredible research, connect with amazing collaborators and travel this beautiful country."



Trevyn Toone, USA
Science PhD



"For me, the support of my supervisors is what makes my journey as a PhD researcher special."



Maria Eleni Pouliasi, Greece
Law PhD



"Both the University and New Zealand have a very good work-life balance as prospective places to work and live."



Igor Felipe, Brazil
Medical and Health Sciences PhD



auckland.ac.nz/meet-international-students



"The University has a strong alumni network and excellent resources to help support your studies, as well as excellent academic programmes and teaching staff."



Xiao Shen Hu (Remy), Canada
Medical and Health Sciences undergraduate



"I wanted to be part of a community of scholars passionate about making a positive impact on the environment, so it made sense to study at the UoA."



Dilieka Weerakoon, Sri Lanka
Engineering PhD



"The sense of inclusivity I felt when I attended Open Day really motivated my decision to study here."

 Rui Ma, China
Education undergraduate



"New Zealand offers one of the best education systems in the world. Don't overthink it – a valuable experience awaits you at the University of Auckland!"

 Marut Soontrong, Thailand
Arts postgraduate



"Being the leading university in New Zealand, as well as offering superb intellectual property courses – UoA was the dream university for me."

 Prachi Shah, India
Law postgraduate



"The support I received from lecturers, tutors and UniServices really helped me settle into my new life in New Zealand."

 Namodh Edirisinghe, Sri Lanka
Science postgraduate



"The Design Programme's laid-back, close-knit community encourages everyone to connect."

Canisha Nadine Handoko, Indonesia
 Creative Arts and Industries undergraduate



"The richest experiences I have had during my studies have been through building relationships, both personally and professionally."

 Janaina Moraes, Brazil
Creative Arts and Industries PhD



"When it came time to find my dream job, I was able to lean on the career development and support services available at the University."

 Doan Thanh Hoa, Vietnam
Business postgraduate



"No sugar coating – the lecturers are amazing and very supportive, and always available to help."

 Guruh Sukarno Putra, Indonesia
Education postgraduate



"I didn't at all feel like I was treated differently as an international student and I enjoyed learning about New Zealand culture."

 Shelby Kua, Malaysia
Arts undergraduate



"I love that Auckland is so diverse. I easily find food that reminds me of home, and experience a wide range of cultures."

 Bryan Li, China
Engineering postgraduate



"The well-furnished, self-catered family accommodation at Carlaw Park Student Village really exceeded my expectations."

 Juliet John Inyang, Nigeria
Business PhD

Arts

Choose interesting. With a degree from New Zealand's highest ranked Arts faculty¹, you will develop the essential skills for a career in today's fast-changing workforce. Study subjects across humanities, social sciences, languages, Indigenous studies, and communication.

At undergraduate level, you can undertake Bachelor of Arts (BA) or a Bachelor of Communication (BC). With a BA, you will explore two chosen subjects in-depth and develop transferable skills, including critical thinking, relationship building, and creative problem-solving. The BC equips you with specialist expertise for a career in communications, marketing, and media. You can also complete a shorter language qualification, either independently or alongside the BA or BC.

For postgraduate, we offer both taught and research-based programmes, some with a professional focus. Pursue advanced study in communication, conflict and terrorism, creative writing, indigenous studies, public policy, or language teaching. The Faculty of Arts is home to internationally acclaimed academics who are leaders in their field, and our teaching is informed by the latest research and knowledge.

¹QS World Rankings by Subject 2023

Undergraduate programmes

Bachelor of Arts

auckland.ac.nz/ba

Bachelor of Communication

auckland.ac.nz/bc

Diploma in Languages

auckland.ac.nz/diplang

Certificate in Languages

auckland.ac.nz/certlang

Arts research

Professor Susanna Trnka is a social and medical anthropologist in the Faculty of Arts.

"My key research areas include the politics of the body and medicine, digital health technologies, political violence and states of emergency. Recently, I've examined the Covid-19 response in New Zealand and the ways it is reshaping how we think about states' and citizens' responsibilities for health.

"In my teaching, I explore the social and cultural context around health issues. It's vital to understand how different circumstances affect the treatment and understanding of wellbeing."

"Don't overthink it – a valuable experience awaits you at the University of Auckland!"

Marut Soontrong

Thailand

Master of Arts in Criminology



Read more

auckland.ac.nz/meet-marut



Postgraduate programmes

Graduate Diploma in Arts

auckland.ac.nz/graddiparts

Bachelor of Arts (Honours)

auckland.ac.nz/ba-hons

Postgraduate Diploma in Arts

auckland.ac.nz/pgdiparts

Postgraduate Diploma in Language Teaching

auckland.ac.nz/pgdiplt

Master of Arts

auckland.ac.nz/ma

Master of Communication

auckland.ac.nz/mc

Master of Conflict and Terrorism Studies

auckland.ac.nz/mcts

Master of Creative Writing

auckland.ac.nz/mcw

Master of Heritage Conservation

auckland.ac.nz/mhercons

Master of Indigenous Studies

auckland.ac.nz/mindigst

Master of Literature

auckland.ac.nz/mlitt

Master of Public Policy

auckland.ac.nz/mpp

Master of Teaching English to Speakers of Other Languages

auckland.ac.nz/mtesol

Master of Theology

auckland.ac.nz/mtheol

Doctor of Philosophy (PhD)

auckland.ac.nz/phd

Give your future more possibilities.

Find out more
arts.auckland.ac.nz



	Bachelors	Honours	PGDip	Taught Masters	Research Masters	Doctorate
Academic English Studies	a					
Academic English Studies and Linguistics	✓					
Anthropology	✓	✓	✓	✓	✓	✓
Applied Linguistics				✓	✓	✓
Art History	✓	✓	✓	✓	✓	✓
Asian Studies	✓	✓	✓	✓	✓	e
Chinese	✓	✓	✓	✓	✓	e
Classical Studies and Ancient History	✓	✓	✓		b	b
Comparative Literature	a					✓
Communication	✓			✓		✓
Conflict and Terrorism Studies				✓	✓	
Cook Islands Māori	a					
Creative Writing	c				✓	
Criminology	✓	✓	✓	✓	✓	✓
Development Studies		✓	✓	✓	✓	✓
Drama	✓	✓	✓	✓	✓	d
Economics	✓	✓	✓	✓	✓	✓
Education	✓	✓	✓	✓	✓	✓
Employment Relations and Organisation Studies	✓	✓	✓	✓	✓	
English	✓	✓	✓	✓	✓	✓
English Writing	a					
European Studies	✓					e
French	✓	✓	✓	✓	✓	e
Gender Studies	✓					✓
Geography	✓	✓	✓	✓	✓	✓
German	✓	✓	✓	✓	✓	e
Global Studies	✓			✓		
Greek (Ancient)						✓
History	✓	✓	✓	✓	✓	✓
Humanities	a					
Indigenous Studies				✓		
Italian	a	✓	✓	✓	✓	e
Japanese	✓	✓	✓	✓	✓	e
Korean	✓					e
Language Teaching			✓			
Latin American Studies						✓
Latin	✓	✓	✓	✓	✓	✓
Linguistics	✓	✓	✓	✓	✓	✓
Logic and Computation	✓					
Māori Studies	✓	✓	✓	✓	✓	✓
Mathematics						✓
Media and Screen Studies	✓	✓	✓	✓	✓	✓
Museums and Cultural Heritage		✓	✓	✓	✓	
Music						✓
Pacific Studies	✓	✓	✓	✓	✓	✓
Philosophy	✓	✓	✓	✓	✓	✓
Politics and International Relations	✓	✓	✓	✓	✓	✓
Psychology	✓			✓	✓	✓
Public Policy				✓	✓	✓
Russian	a					e
Samoan	a					
Screen Production		✓	✓	✓	✓	
Sociology	✓	✓	✓	✓	✓	✓
Spanish	✓	✓	✓	✓	✓	e
Statistics	✓	✓	✓			✓
Teaching English to Speakers of Other Languages (TESOL)	✓			✓		
Theological and Religious Studies	f	✓			✓	✓
Tongan	a					

a. Elective courses only (major not available)

b. Continued under Ancient History

c. Available as part of English for bachelors

d. Available for PhD as English

e. Continues at PhD level as European Languages and Cultures for these subjects: Spanish, Russian, Italian, German, French, European Studies.

Continues at PhD level as 'Asian Languages and Cultures' for these subjects: Asian Studies, Korean, Japanese, Chinese

f. Subject called "Theological and Religious Studies" at undergraduate level, and "Theology" at postgraduate level

g. Also available as a Postgraduate Certificate

Business

We are one of Asia-Pacific's foremost research-led business schools. We're known for excellence and innovation in research, learning and partnership with enterprise. Our internationally qualified staff, up-to-date technology, and strong focus on student development mean that from day one you will receive a business education that is among the best on offer in New Zealand.

We hold leading international accreditations, including the triple crown: AACSB International, EQUIS and AMBA. These accreditations are your assurance of the highest academic standards. They offer global credibility and recognition.

University of Auckland Business School graduates occupy leading positions in business and professions within New Zealand and around the world. The home of the Business School is the Sir Owen G Glenn Building, an iconic facility that is designed to promote a sense of community among staff and students. It's an extraordinary learning environment.

Undergraduate programmes

Bachelor of Commerce
auckland.ac.nz/bcom

Bachelor of Property
auckland.ac.nz/bprop

Undergraduate Commerce conjoint options:
Advanced Science (Honours); Arts; Communication; Design; Engineering (Honours); Fine Arts; Global Studies; Health Sciences; Laws; Laws (Honours); Music; Property; Science; Sport; Health and Physical Education

Undergraduate Property conjoint options:
Advanced Science (Honours); Commerce; Design; Engineering (Honours); Global Studies; Laws; Laws (Honours); Science

Postgraduate programmes

Bachelor of Commerce (Honours)
auckland.ac.nz/bcom-hons

Master of Commerce
auckland.ac.nz/mcom

Doctor of Philosophy (PhD)
auckland.ac.nz/phd

Professional programmes

Master of Applied Finance
auckland.ac.nz/mappfin

Master of Business Analytics
auckland.ac.nz/mbusan

Master of Management
auckland.ac.nz/mmgmt

Master of Professional Accounting
auckland.ac.nz/mprofacctg

Learn more about our Professional programmes:
businessmasters.auckland.ac.nz



Innovative learning spaces

You'll have lots of opportunities to develop in-demand professional skills in the Business School's specialist learning spaces, including the brand-new BNZ Financial Trading Room and Te Ahi Hangarau Technology Hub.

Our undergraduate programmes are all about interactive learning. Your first-year core courses, award-winning Business Consulting course and workshops will utilise these innovative new learning spaces.

For postgraduate students and researchers, these specialist spaces offer you unique opportunities for learning, collaboration, research, ideation, testing and prototyping.

BNZ Financial Trading Room

Get first-hand experience of New Zealand and global capital markets. Make deals, trade and manage portfolios in our state-of-the-art simulated trading room.

Te Ahi Hangarau Technology Hub Powered by One NZ

Explore the potential of 5G in the brand-new technology hub – the first of its kind in New Zealand. Equipped with virtual reality headsets, 3D printers, smart home IoT devices and more.

Kura Matahuna – Unleash Space

Let your creativity run wild in our maker space, with equipment such as 3D printers and laser cutters. Unleash Space is free to all students and staff.





Prepare for the real world of business with real-world learning

Find out more
auckland.ac.nz/business
businessmasters.auckland.ac.nz

“With my experience here so far, I can see why the University of Auckland is the top university in New Zealand.”

Sangvin is studying a Master of Professional Accounting (MProfAcctg) having graduated with a Bachelor of Arts, Economics from the University of California Davis, and a Master of Law and Diplomacy from Tufts University in Boston.

Alongside his MProfAcctg, Sangvin is also an undergraduate teaching assistant in the Business School.

“I was drawn to the University because I’d heard about the renowned academic programmes on offer, taught by highly respected teaching staff. There’s also a strong alumni network here and excellent resources to help support your studies.”

“My lecturers are great at explaining complex concepts and topics, and they’re always available to offer extra help if I need it.”

“The MProfAcctg is an 18-month coursework-based programme which is pretty fast-paced and keeps me focused. I’m definitely going through a period of great self-development and personal growth on this programme, and I’m really enjoying meeting and learning from students from such diverse backgrounds.”

“I hope to settle in Auckland once I graduate, and find work as an accountant or similar in the financial and private business sector. I am confident that through this programme I will come away with the skills and knowledge I need to achieve my goals.”

Sangvin Chey

South Korea
 Master of Professional Accounting

	Bachelors	Honours	Taught Masters	Research Masters	Professional Masters	Doctorate
Accounting	✓	✓	✓	✓	a	✓
Business Analytics	✓				a	
Commercial Law	✓	✓	✓	✓	b	✓
Economics	✓	✓	✓	✓		✓
Finance	✓	✓	✓	✓	a	✓
Global Management and Innovation		✓	✓	✓		
Human Resource Management					a	
Information Systems	✓	✓	✓	✓		✓
Innovation and Entrepreneurship	✓			Refer to Management		
International Business	✓				a	✓
Management	✓				a	✓
Marketing	✓	✓	✓	✓	a	✓
Operations and Supply Chain Management	✓	✓	✓	✓		✓
Property	✓				b	✓
Taxation	✓					

a. These fully taught masters programmes are open to applicants with a bachelors degree in an unrelated area of study.

b. Offered fully online. Note: These programmes are open to international students but designed for a domestic audience.

Creative Arts and Industries

Study at New Zealand's leading university for Architecture/
Built Environment and Performing Arts¹. Join our lively teaching
environment filled with fellow creatives and internationally recognised
artists, practitioners, teachers and researchers. We offer programmes
in Architecture, Dance, Design, Fine Arts, Music, Urban Design and
Urban Planning.

Creative Arts and Industries research

Dr Angus Campbell is Director of Design and Deputy Head of Elam School of Fine Arts and Design.

His lecturing, practice-based research and freelance design experience are focused on investigating and using design in a way that brings together complex social, technological and ecological systems. He aims to address contemporary needs, such as finding ways to produce food in a sustainable way.

"Design is about thinking about how creative solutions can be embedded locally and providing solutions for complex problems. We're faced with a global sustainability crisis, which presents a huge opportunity for designers and a philosophical shift, to engage with the complexity of these problems."

We encourage imaginative thinking, fresh ideas and innovation. Study with us will help set you up for a life of research, discovery and practice that contributes to the future development of society across multiple sectors. Our strong links with national and international creative communities enable you to connect and foster relationships with relevant professional and business organisations as part of your study.

The PhD is available for advanced research across all our disciplines. You can also choose a Doctor of Fine Arts or PhD with scholarly creative work to link theory with practical elements such as contemporary art, design, performance or film as you build your research and final submission.

Undergraduate programmes

Bachelor of Architectural Studies

auckland.ac.nz/bas

Bachelor of Dance Studies

auckland.ac.nz/bdancest

Bachelor of Design

auckland.ac.nz/bdes

Bachelor of Fine Arts

auckland.ac.nz/bfa

Bachelor of Music

auckland.ac.nz/bmus

Bachelor of Urban Planning (Honours)

auckland.ac.nz/burbplan-hons

Graduate Diploma in Architectural Studies

auckland.ac.nz/graddipas

Graduate Diploma in Music

auckland.ac.nz/graddipmus

Undergraduate Design conjoint combinations:

Advanced Science (Honours), Arts, Commerce, Engineering (Honours), Fine Arts, Global Studies, Health Sciences, Law (including Honours), Music, Property, Science

Undergraduate Fine Arts conjoint combinations:

Advanced Science (Honours), Arts, Commerce, Communication, Design, Engineering (Honours), Global Studies, Health Sciences, Law (including Honours), Music, Science

Undergraduate Music conjoint combinations:

Advanced Science (Honours), Arts, Commerce, Design, Engineering (Honours), Fine Arts, Global Studies, Law (including Honours), Science

Postgraduate programmes

Bachelor of Dance Studies (Honours)

auckland.ac.nz/bdancest-hons

Bachelor of Music (Honours)

auckland.ac.nz/bmus-hons

Postgraduate Certificate in Design

auckland.ac.nz/pgcertdes

Postgraduate Certificate in Music

auckland.ac.nz/pgcertmus

Postgraduate Diploma in Architecture

auckland.ac.nz/pgdiparch

Postgraduate Diploma in Dance Studies

auckland.ac.nz/pgdipdancest

Postgraduate Diploma in Fine Arts

auckland.ac.nz/pgdipfa

Postgraduate Diploma in Music

auckland.ac.nz/pgdipmus

Master of Architecture

auckland.ac.nz/march

Master of Architecture (Professional)

auckland.ac.nz/marchprof

Master of Architecture (Professional) and Heritage Conservation

auckland.ac.nz/marchprofhercons

Master of Architecture (Professional) and Urban Design

auckland.ac.nz/marchprofurbdes

Master of Architecture (Professional) and Urban Planning (Professional)

auckland.ac.nz/marchprofurbplanprof

Master of Community Dance

auckland.ac.nz/mcommdance

Master of Dance Movement Therapy

auckland.ac.nz/mdmt

Master of Dance Studies

auckland.ac.nz/mdancest

Master of Design

auckland.ac.nz/mdes

Master of Fine Arts

auckland.ac.nz/mfa

Master of and Heritage Conservation

auckland.ac.nz/mhercons

Master of Music

auckland.ac.nz/mmus

Master of Urban Design

auckland.ac.nz/murbdes

Master of Urban Planning

auckland.ac.nz/murbplan

Master of Urban Planning (Professional)

auckland.ac.nz/murbplanprof

Master of Urban Planning (Professional) and Heritage Conservation

auckland.ac.nz/murbplanprofhercons

Master of Urban Planning (Professional) and Urban Design

auckland.ac.nz/murbplanprofurbdes

Doctor of Fine Arts (DocFA)

auckland.ac.nz/docfa

Doctor of Philosophy (PhD)

auckland.ac.nz/phd

¹QS World University Rankings by Subject 2023

	Bachelors	Honours	GradDip	PGCert	PGDip	Taught Masters	Research Masters	Combined Masters	Professionally Accredited Masters (a)	Doctorate
Architecture	✓		✓		✓	✓	✓	b	✓	✓
Community Dance							✓			
Dance Studies	✓	✓			✓	✓				✓
Dance Movement Therapy							✓			
Design	✓			✓		✓	✓			✓
Fine Arts	✓				✓	✓	✓			c
Heritage Conservation				✓		✓		d		✓
Music	e	✓	✓	✓	✓	✓	✓			✓
Urban Design						✓		f		✓
Urban Planning		✓				✓	✓	g	✓	✓

- a. Recognised by the relevant professional organisations
- b. Available as a combined masters degree with: Heritage Conservation; Urban Design; or Urban Planning (Professional). You can complete two masters degrees in less time.
- c. You can study a PhD in Fine Arts or a Doctor of Fine Arts (DocFA).
- d. Available as a combined masters degree with: Architecture (Professional); or Urban Planning (Professional). You can complete two masters degrees in less time.
- e. Specialise in Music Studies with portfolios in: Ensemble Direction; Learning, Community and Engagement; Music Education; Music Production; or Musicology. Specialise in Creative Practice with portfolios in: Classical; Composition; Jazz; or Popular Music.
- f. Available as a combined masters degree with: Architecture (Professional); or Urban Planning (Professional). You can complete two masters degrees in less time.
- g. Available as a combined masters degree with: Architecture (Professional); Heritage Conservation; or Urban Design. You can complete two masters degrees in less time.



Join us to
imagine, inspire
and create a
better world.

Find out more
auckland.ac.nz/creative

“I am passionate about building relationships between artists, art communities and academia.”

The autonomous nature of the Dance Studies programme empowered Janaína Moraes to design her own PhD journey.

“I first contacted my supervisors when I was still in Brazil. I sensed a genuinely welcoming atmosphere. I was surprised by how much care and investment they put into supporting me from afar. Coming from another country, I knew there would be differences in how research is done. Their guidance made a huge difference in helping me understand how the PhD programme works at the University of Auckland.”

“My doctoral research investigates notions of residence, invitation poetics and practices of language transition. These are umbrella terms for a dance practice that is invested in an expanded understanding of choreography, where social, pedagogical, political and relational fields are valued as dance processes.”

“Through my research, I have had the pleasure of connecting with so many cultures, languages and ways of experiencing the world! There is a beautiful and diverse cohort of students and staff at the University of Auckland.”

“The richest experiences I have had during my studies have been through building relationships, both personally and professionally.”

“My studies have definitely broadened my perspective on how to make this happen, and I am keen to collaborate with other professionals and scholars to foster these connections.”

Janaína Moraes

Brazil
PhD in Dance Studies

Education and Social Work

The University of Auckland is New Zealand's leading university for Education – ranked 37th in the world¹, and the only New Zealand university to feature in the global top 50. Our staff are nationally and internationally recognised for their teaching and research, and our graduates are sought after by employers in local and global markets.

Our faculty offers a broad range of programmes and attracts diverse students from around the world. The Faculty of Education and Social Work is committed to leading learning and changing lives, with social justice at the heart of everything we do.

In many of our programmes, you will apply your learning through practical experience in the community. Our varied and extensive research contributes to the educational success, health, and wellbeing of individuals and communities, as well as policy formation.

Our masters and doctoral research programmes allow you to focus on research that can be applied in your area of interest. This is an opportunity to contribute valuable knowledge and understanding to your field.

Undergraduate programmes

Bachelor of Early Childhood Studies
auckland.ac.nz/beecs

Bachelor of Education (Teaching) Primary specialisation
auckland.ac.nz/bedtchg

Bachelor of Education (Teaching English to Speakers of Other Languages)
auckland.ac.nz/bedesol

Bachelor of Sport, Health and Physical Education
auckland.ac.nz/bsporthpe

Bachelor of Social Work
auckland.ac.nz/bsw

Bachelor of Arts in Education
education.auckland.ac.nz/bae

Social Work research

Dr Ritesh Shah's research is driven by the ambition, signalled in the Sustainable Development Goals, that all children inherit a world that is more just, equitable and peaceful than the one we inhabit today. His research investigates how quality, relevant, inclusive education in conflict and crisis-affected contexts can contribute to this goal.

In 2017, Ritesh was recognised with the Early Career Research Excellence Award. His commendation notes, "He undertakes this innovative and ground-breaking research and scholarship, not because it will further his career but because he wishes to make a difference to vulnerable populations caught up in the aftermath of international conflicts and disasters."

Ritesh teaches on several education courses in the Faculty of Education and Social Work and supervises postgraduate students working towards their masters and doctoral degrees.



Postgraduate programmes

Graduate diploma in teaching

Graduate Diploma in Teaching (ECE)
auckland.ac.nz/graddiptchg-ece

Graduate Diploma in Teaching (Primary)
auckland.ac.nz/graddiptchg-primary

Graduate Diploma in Teaching (Secondary)
auckland.ac.nz/graddiptchg-sec

Postgraduate study in education

Bachelor of Arts (Honours) in Education
education.auckland.ac.nz/baehons

Bachelor of Education (Teaching)(Honours)
auckland.ac.nz/bedtchg-hons

Postgraduate Certificate in Education
auckland.ac.nz/pgcerted

Postgraduate Certificate in Regional Development
auckland.ac.nz/pgcertregdev

Postgraduate Diploma in Education
auckland.ac.nz/pgdiped

Postgraduate Diploma in Educational Leadership
auckland.ac.nz/pgdipedld

Master of Education
auckland.ac.nz/med

Master of Education Practice
auckland.ac.nz/medprac

Master of Educational Leadership
auckland.ac.nz/medld

Master of Arts in Education
auckland.ac.nz/ma

Master of Professional Studies in Education
auckland.ac.nz/mprofstuds-ed

Master of Professional Studies in Mathematics Education
education.auckland.ac.nz/mps-maths

Master of Regional Development
auckland.ac.nz/mrd

Doctor of Philosophy (PhD) in Education
education.auckland.ac.nz/phd-education

Postgraduate study in counselling, social and community leadership or social work

Bachelor of Social Work (Honours)
auckland.ac.nz/bsw-hons

Postgraduate Certificate in Social and Community Leadership
auckland.ac.nz/pgcertscl

Postgraduate Diploma in Counselling Theory
auckland.ac.nz/pgdipcounsth

Postgraduate Diploma in Social Work
auckland.ac.nz/pgdipsw

Master of Counselling
auckland.ac.nz/mcouns

Master of Social Work
auckland.ac.nz/msw

Master of Social Work (Professional)
auckland.ac.nz/mswprof

Master of Social and Community Leadership
auckland.ac.nz/mscl

Doctor of Philosophy (PhD) in Social Work
auckland.ac.nz/phd-social-work

¹QS World University Rankings by Subject 2023



Number one university in New Zealand for Education¹

Find out more
education.auckland.ac.nz

“Studying Primary Teaching has helped me to develop the soft skills I will carry with me for the rest of my life.”

Rui is an international officer for the Education and Social Work Student Association. She hopes to graduate from the Bachelor of Education (Teaching) Primary programme with the skills needed to create a diverse and inclusive educational environment to empower her future students.

“Belonging’ is the best word to describe my experience of being an international student at the University. At O-Week we were brought together from all corners of the world to fulfil our dreams and celebrate the start of our journeys. The University embraces everyone and provides an inclusive environment to safely share and learn from others.

“The support and belonging I feel here has given me the confidence to become an international officer so that I too can help other students improve their university lives.

“Auckland itself is a beautiful city. I love the urban-rural mix where you can enjoy the vibrant, fast-paced town and night views of the harbour, but also the serenity of nature as you walk through the bush or spend a day at the beach.

“For me, the biggest benefit of studying for a Bachelor of Education (Teaching) Primary is that I can enhance my communication and teamwork skills and learn professional educational concepts that I can then apply to my future career.

“My advice for those considering moving here to study at the University of Auckland is that you should never limit yourself because here you will have all the help and guidance you need to reach your potential.”

Rui Ma

China
 Bachelor of Education (Teaching) Primary

	Bachelors	GradDip	Honours	PGCert	PGDip	Taught Masters	Research Masters	Doctorate
Counselling					✓	TBC	✓	a
Early Childhood Studies	✓						TBC	
Education	✓		✓	✓	✓		✓	a
Education Practice						✓		a
Educational Leadership					✓	✓	✓	a
Higher Education				✓		✓		
Professional Studies						✓		a
Sport, Health and Physical Education	✓							a
Social Work	✓		✓		✓	✓	✓	a
Social and Community Leadership				✓		TBC	✓	a
Teaching (Early Childhood)		✓						
Teaching (Primary)	✓	✓						
Teaching (Secondary)		✓						
Teaching English as a Second Language	✓			✓	✓			

a. Available as a research area in the associated department, subject to the availability of these topics and supervisors

Engineering

The Faculty of Engineering/Te Herenga Mātai Pūkaha provides internationally-recognised qualifications to innovators and problem-solvers, equipping them with the tools the tools required to build a better tomorrow. As New Zealand's leading Engineering faculty*, we offer a wide selection of undergraduate and postgraduate programmes across five departments.

The CIRCUIT Centre

The Circular Innovations (CIRCUIT) Research Centre is one of our 17 world-class research facilities. It connects research with communities and businesses to develop a circular economy, where products are reused and new resources extracted. CIRCUIT works to make Aotearoa and the world a more sustainable place. Associate Professor Saeid Baroutian is the Director of CIRCUIT and one of our leading researchers on sustainability. Saeid's research interests lie in Process Engineering and his expertise centres on the development and design of circular economies, resource recoveries and waste minimisation. Recently Saeid and his team have found a way to turn non-recyclable personal protective equipment into water and vinegar. They are the harmless products of a process that involves shredding masks, gowns, gloves and plastic safety glasses, and compressing them into a machine with hot, pressurised water.

Read more
circuit.auckland.ac.nz



Our graduates are employable worldwide! We provide work experience for all students which leads to an accreditation from Engineering New Zealand. We also foster close relationships with industry partners to prepare you for your career and to open networking opportunities. Postgraduate students can work on globally significant projects alongside internationally respected researchers at our state-of-the-art research facilities. Our programmes include taught and research options that are tailored to a variety of backgrounds and skill levels. These suit people who have undergraduate degrees, as well as those who are already working in industry. All of our programmes aim to enrich your knowledge and enhance your employability. The Faculty of Engineering houses 17 world-class research centres that enable the best engineering and cross-disciplinary research in New Zealand. They range across all our specialisations and include wind tunnels, 3D printing labs and Australasia's largest 'strong wall', which is used to test civil structures.



Undergraduate programme

Bachelor of Engineering (Honours)
auckland.ac.nz/be-hons

Postgraduate programmes

- Postgraduate Certificate in Geothermal Energy Technology**
auckland.ac.nz/pgcertgeothermtech
- Master of Aerospace Engineering*****
auckland.ac.nz/maerospaceeng
- Master of Earthquake Engineering****
auckland.ac.nz/meqeng
- Master of Energy**
auckland.ac.nz/menergy
- Master of Engineering*****
auckland.ac.nz/me
- Master of Engineering Management**
auckland.ac.nz/memgt
- Master of Engineering Project Management**
auckland.ac.nz/mepm
- Master of Engineering Studies**
auckland.ac.nz/mengst
- Master of Infrastructure Asset Management (MInfraAssetMgt)*****
auckland.ac.nz/minfraassetmgt
- Master of Materials Engineering (MMaterialsEng)*****
auckland.ac.nz/pgcertmedicaleng
- Master of Medical Engineering (MMedicalEng)*****
auckland.ac.nz/mmedicaleng
- Master of Operations Research and Analytics*****
auckland.ac.nz/moran
- Master of Robotics and Automation Engineering*****
auckland.ac.nz/mroboteng
- Master of Engineering Studies in Sustainable Resource Recovery (MEngSt)*****
auckland.ac.nz/srr
- Doctor of Philosophy (PhD)**
auckland.ac.nz/phd

*QS World University Rankings by Subject 2023

**Also available as a Postgraduate Certificate

***Also available as a Postgraduate Certificate and a Postgraduate Diploma



**Join us
to develop
technologies that
make the world
better**

Find out more
engineering.auckland.ac.nz

“I wanted to be part of a community of scholars and professionals passionate about making a positive impact on the environment. So it made sense to study at the University of Auckland.”

Dilieka Weerakoon

Sri Lanka
PhD in Chemical and Materials Engineering



Read more
auckland.ac.nz/meet-dilieka

	Bachelors (Honours)	PGCert	PGDip	Taught Masters	Research Masters	Doctorate
Aerospace Engineering		✓	✓	✓	✓	r
Bioengineering					r	✓
Chemical and Materials Engineering	✓	✓	✓	✓	✓	✓
Civil Engineering	✓	✓	✓	✓	✓	✓
Computer Systems Engineering	✓	✓	✓	✓	✓	✓
Construction Management				✓	r	r
Earthquake Engineering		✓		✓	r	r
Electrical and Electronic Engineering	✓	✓	✓	✓	✓	✓
Energy	a			✓	✓	r
Engineering Management	b			✓	r	r
Engineering Science	✓	✓	✓	✓	✓	✓
Environmental Engineering	a	✓	✓	✓	✓	r
Food Engineering		✓	✓	✓	✓	r
Geotechnical Engineering				✓	✓	r
Geothermal Energy Technology		✓		✓	r	r
Infrastructure Asset Management		✓	✓	✓	r	r
Materials Engineering		✓	✓	✓	✓	r
Mechanical Engineering	✓	✓	✓	✓	✓	✓
Mechatronics Engineering	✓	✓	✓	✓	✓	✓
Medical Engineering		✓	✓	✓	r	r
Operations Research and Analytics	c	✓	✓	✓	✓	✓
Polymers		✓	✓	✓	✓	r
Project Management	✓	✓		✓	r	r
Robotics and Automation		✓	✓	✓	r	r
Software Engineering	✓	✓	✓	✓	✓	✓
Structural Engineering	✓					
Sustainable Resource Recovery		✓	✓	✓	r	r
Transportation Engineering		✓	✓	✓	✓	r

a. Interfaculty with Science and Business
b. Interfaculty with Business

c. Interfaculty with Science
r. Available as a research area in the associated department

Law

The University of Auckland Law School is ranked 62nd in the 2023 QS World University Rankings by Subject. That's top in New Zealand. We're also the best place to study Law in New Zealand, according to academic reputation, employer reputation and research impact.

Our undergraduate and postgraduate programmes offer a wider range of courses than any other Law school in New Zealand.

The Auckland Law School has a long tradition of excellence, founded on the calibre of our staff, students and resources. We are committed to improving access to justice through excellence in teaching, research, service and engagement. Our programmes are taught by a range of leading experts, including our own academic staff, pre-eminent members of the profession and distinguished academic visitors from abroad.

Located in the heart of Auckland's legal precinct, the Law School is also home to the Davis Law Library, New Zealand's most extensive collection of legal resources.

Conjoint degrees with Law

Conjoint degrees enable you to complete the requirements of two degrees simultaneously, only adding one year of study to the longest degree in most cases.

law.auckland.ac.nz/conjoints



No.1
in New Zealand
62nd
worldwide¹

1. Times Higher Education World University Rankings 2023 and QS World University Rankings 2023

Undergraduate programmes

Bachelor of Laws
auckland.ac.nz/llb

Bachelor of Laws (Honours)
auckland.ac.nz/llb-hons

Postgraduate programmes

Graduate Certificate in Law
auckland.ac.nz/gradcertlaw

Graduate Diploma in Law
auckland.ac.nz/graddiplaw

Postgraduate Certificate in Law
auckland.ac.nz/pgcertlaw

Master of Laws
auckland.ac.nz/llm

Master of Legal Studies
auckland.ac.nz/mls

Master of Taxation Studies
auckland.ac.nz/mtaxs

Doctor of Philosophy (PhD)
lawfellowship.ac.nz

Law research

Professor Jodi Gardner is the inaugural Brian Coote Chair in Private Law, coming to the University of Auckland after completing her DPhil at Oxford and working as a Fellow of Law at Cambridge. Jodi is interested in the law's relationship with inequality, particularly how apparently neutral private law rules can exacerbate existing vulnerabilities.

Jodi's research focuses on the relationship between the private law and social policy. She analyses how private law doctrines interact with social welfare, including the limitations of doctrinal law in responding to the challenges posed by poverty and inequality.

Known for her interdisciplinary approach to research, Jodi is currently working on a project with Professors Mia Gray (Cambridge) and Frederick Wherry (Princeton), looking at the post-pandemic economic system, and focusing on its relationship with debt and inequality.

	Bachelors	Honours	GradCert	GradDip	PGCert	Taught Masters	Research Masters	Doctorate
Law*	✓	✓	✓	✓	✓	✓	✓	✓
Taxation Studies						✓	✓	✓
Legal Studies						✓	✓	

*For first year in Law, you will apply for LLB Part I and one other bachelors degree programme to satisfy the Law Part I requirement for five non-Law courses. If you gain selection into LLB Part II you can continue studying your second degree as a conjoint with Law. A conjoint degree gives you the opportunity to acquire a wider knowledge base and broaden your career opportunities. You can combine your Law degree with a degree in Advanced Science (Honours), Arts, Commerce, Communication, Design, Engineering (Honours), Fine Arts, Global Studies, Health Sciences, Music, Property or Science.





**One degree,
unlimited potential
at New Zealand's
top-ranked Law
school**

Find out more
law.auckland.ac.nz

“I zeroed in on New Zealand as my study destination. Choosing to enrol at the University of Auckland was a no-brainer.”

Prachi worked as an intellectual property, media and entertainment lawyer in India after completing her undergraduate degree in Mumbai. She's now studying for her Master of Laws (LLM) in Intellectual Property Law at the Auckland Law School.

“Being the leading university in New Zealand, as well as offering superb intellectual property courses, the University of Auckland was the dream Law School for me.

“Everything was going fine until Covid-19 brought the world to a standstill and made me reassess my life. I had always dreamed of delving deeper into international laws surrounding intellectual property rights, and the pandemic accelerated the process of achieving this dream.

“I was determined to study in New Zealand, and as one of the most reputed universities in the world, the University of Auckland was my first choice.

“My study covers all aspects of intellectual property along with dedicated research on copyrights.

“My chosen specialisation enables me to protect a person's invention or artistic creativity, and even the brand name of a company. It allows me to fight for those rights that most people are unaware of.

“During my time so far at the University, I have assisted Associate Professor Rob Batty with research on a number of topics related to intellectual property. I've also had the opportunity to mark the scripts of undergraduate students.

“I am now more driven than ever to continue down this path, and study for a PhD in the future.”

Prachi Shah

India
Master of Laws (LLM),
Intellectual Property Law

Medical and Health Sciences



At Mātauranga Hauora – Faculty of Medical and Health Sciences, we are dedicated to helping you uncover your potential and make a positive difference for future generations and in the world of medical and health sciences.

Our modern facilities at Grafton Campus are located across the road from Auckland City Hospital and the beautiful Auckland Domain. Since our beginnings in 1968, we have become internationally recognised as a comprehensive medical and health sciences faculty.

As an international student, you can choose from a range of undergraduate and postgraduate programmes in Medicine, Nursing, Medical Imaging, Medical Sciences, Pharmacy, Optometry, Population Health and a variety of Science disciplines. You'll be taught by expert lecturers and renowned researchers in world-class facilities and make life-long connections with fellow students.

We're a research powerhouse, with four University Research Centres, including the Centre for Brain Research, Centre for Cancer Research, Centre for Co-Created Ageing Research, Centre for Pacific and Global Health. We also host dedicated Faculty Research centres and a Centre for Research Excellence focused on heart health. Our research teams in these areas provide nurturing and highly supportive postgraduate training in an innovative learning environment.

“To be in a place so connected to diversity, nature and people is a great privilege in my student life.”

Xiao Shen Hu (Remy)



Canada
 Bachelor of Medicine and Bachelor of Surgery
 Read more
auckland.ac.nz/meet-remy

Undergraduate programmes

Bachelor of Health Sciences
auckland.ac.nz/bhsc

Bachelor of Medicine and Bachelor of Surgery
auckland.ac.nz/mbchb

Bachelor of Medical Imaging (Honours)
auckland.ac.nz/bmedimag-hons

Bachelor of Nursing
auckland.ac.nz/bnurs

Bachelor of Optometry
auckland.ac.nz/boptom

Bachelor of Pharmacy
auckland.ac.nz/bpharm

Bachelor of Nursing (Honours)
auckland.ac.nz/bnurs-hons

Postgraduate Certificate in Clinical Education/Health Sciences
auckland.ac.nz/pgcertclined
auckland.ac.nz/pgcerthsc

Postgraduate Diploma in Biomedical Science/Clinical Education/Health Sciences/Obstetrics and Medical Gynaecology/Public Health
auckland.ac.nz/pgdipbiomedsc
auckland.ac.nz/pgdipclined
auckland.ac.nz/pgdiphsc
auckland.ac.nz/pgdipph

Postgraduate Diploma in Science in Optometry/Pharmacology/Physiology
auckland.ac.nz/pgdipsci

Master of Audiology
auckland.ac.nz/maud

Master of Biomedical Science
auckland.ac.nz/mbiomedsc

Master of Clinical Education
auckland.ac.nz/mclined

Master of Health Leadership
auckland.ac.nz/mhlthld

Master of Health Practice
auckland.ac.nz/mhlthprac

Master of Health Psychology
auckland.ac.nz/mhealthpsych

Master of Health Sciences
auckland.ac.nz/mhsc

Master of Nursing
auckland.ac.nz/mnurs

Master of Nursing Practice
auckland.ac.nz/mnursprac

Master of Nursing Science
auckland.ac.nz/mnsc

Master of Public Health
auckland.ac.nz/mph

Master of Science in Optometry/Pharmacology/Physiology
auckland.ac.nz/msc

Doctor of Medicine
auckland.ac.nz/md

Doctor of Philosophy (PhD)
auckland.ac.nz/phd

Medical and Health Sciences research

The Pūtahi Manawa | Healthy Hearts for Aotearoa New Zealand Centre of Research Excellence (CoRE) is a national network of researchers, clinicians and community groups aiming to achieve heart health equity for all New Zealanders. Cardiovascular disease is the single biggest contributor to the difference in life expectancy between Māori and Pacific and other New Zealanders.

Professor Julian Paton, Centre co-Director, says, “Our vision is to harness our multidisciplinary expertise to drive world-class, translational science to deliver more precise diagnosis, risk prediction and treatment.”

“Guided by our Māori and Pacific leadership, we are pioneering a new way of working in research and health,” says co-Director Dr Anna Rolleston.

Postgraduate programmes

Bachelor of Biomedical Science (Honours)
auckland.ac.nz/bbiomedsc-hons

Bachelor of Health Sciences (Honours)
auckland.ac.nz/bhsc-hons

Bachelor of Medical Science (Honours)
auckland.ac.nz/bmedsc-hons



		Bachelors	Honours	Diploma	PGCert	PGDip	Taught Masters	Research Masters	Doctorate
Advanced Nursing	b				a	a			
Alcohol and Drug Studies (within Health Practice)	b				c	c	m	d	e
Anaesthesiology								d	✓
Anatomy					d	d	d	d	✓
Audiology								f	✓
Behavioural Science					d	d	d	d	
Biomedical Science		✓	✓			✓		✓	✓
Clinical Education					✓	✓	✓	✓	h
Community Health					d	d	d	d	
Digital Health	b				✓	✓	d	d	e
General Practice and Primary Health Care					a,d	a,d	d	d	i
Global Health (within Health Leadership)							m		
Health Leadership							✓		
Health Management (within Health Leadership)							m		
Health Practice							✓		✓
Health Promotion (within Health Practice)						✓	m	d	e
Health Psychology						✓		f	✓
Health Sciences	b	✓	✓		✓	✓	✓	✓	✓
Infant, Child and Adolescent Mental Health (within Health Practice)	b				c	c	m	d	g
Magnetic Resonance Imaging (MRI)	b					c	c,d	c,d	
Mammography	b				c,j		c,d,j	c,d,j	
Māori and Pacific Health	b					✓	d	d	✓
Medical Imaging	b	✓			j	j	d,j	d,j	✓
Medical Sciences			✓						
Medicine									✓
Medicine and Surgery (MBChB)		✓							c
Mental Health Nursing	b				a	a			
Molecular Medicine									✓
Nuclear Medicine	b					c	c,d	c,d	
Nursing		✓	✓				a	a	✓
Nursing Practice							a,c,m		
Nursing Science							✓		
Nutrition					d	d			
Nutrition and Dietetics	b							f	e
Obstetrics and Gynaecology						a	a,d	a,d	a
Ophthalmology							c,d		✓
Optometry		✓				✓	d	✓	✓
Pacific Health (within Health Practice)						✓	m	d	k
Paediatrics*					✓a,c	✓a,c	✓a,c	a,c,d	a
Palliative Care	b				c	c	d		
Pathology									✓
Pharmaceutical Science	b				✓	✓			
Pharmacology		✓	✓			d	d	d	✓
Pharmacy	b	✓	✓						✓
Physiology	b	✓	✓			d	d	d	✓
Population Mental Health (within Health Practice)	b					c	m		
Psychiatry									✓
Public Health	b					✓	✓	✓	e
Surgery									✓
Ultrasound	b					c	c,d	c,d	
Women's Health	b				a,c				
Youth Health	b				✓	✓	d	d	

**Extensive
hands-on
experience and
support from
experts**

Find out more
auckland.ac.nz/fmhs

- a. Must be registered with an approved professional body
- b. Named specialisation available for postgraduate study
- c. Must have access to an approved clinical environment
- d. Specialisation not offered in this programme, but relevant study is available through Health Science or Public Health programmes
- e. Available under a PhD in Health Sciences
- f. One year coursework plus one year research (two years in total)
- g. Available under a PhD in Psychiatry
- h. Available under a PhD in Medicine
- i. Available under a PhD in General Practice
- j. Must be registered with the New Zealand Medical Radiation Technologists Board or appropriate body in country of domicile
- k. Available under a PhD in Māori and Pacific Health
- m. 180-point taught masters programme

Science

The Faculty of Science is held in high regard internationally for outstanding quality teaching and diverse research opportunities. Our staff include the largest group of top-ranked, internationally renowned, academic scientists in New Zealand. We'll present you with knowledge at the cutting edge of science.

The Faculty of Science is also the largest science faculty in New Zealand¹, with over 8,000 students (22% International)² and a large variety of subjects available at both undergraduate and postgraduate level.

New Zealand's unique geological history, its biota, climate and location in the South West Pacific provide opportunities to apply science to many environmental and global problems.

1. science.auckland.ac.nz/excellence
2. EFTS equivalent published in 2020
3. Offered in 2024 subject to regulatory approval

Science research

Associate Professor Bruce Burns is a plant ecologist with extensive experience researching New Zealand and overseas ecosystems. He is programme director for the new Master of Ecology.

"My research interests cover the field of plant ecology in seeking to understand determinants and mechanisms of plant persistence, distribution, and abundance. I am particularly interested in species-level positive feedback mechanisms, and the implications and applications of these to biodiversity conservation and ecological restoration.

"The Master of Ecology is a new programme designed to provide students with the skills and knowledge for careers as professional ecologists. As well, it provides opportunities for independent ecological research in the challenging but beautiful Auckland environment, rich in natural areas and biodiversity."

Undergraduate programmes

Bachelor of Science

auckland.ac.nz/bsc

Bachelor of Advanced Science (Honours)

auckland.ac.nz/badv-sci-hons

Graduate Diploma in Science

auckland.ac.nz/graddipsci

Postgraduate programmes

Bachelor of Science (Honours)

auckland.ac.nz/bsc-hons

Postgraduate Certificate in Data Science³

science.auckland.ac.nz

Postgraduate Certificate in Information Technology

auckland.ac.nz/pgcertinfotech

Postgraduate Certificate in Mathematical Modelling

auckland.ac.nz/pgcertmathmodel

Postgraduate Diploma in Applied Psychology

auckland.ac.nz/pgdipapppsych

Postgraduate Diploma in Bioscience Enterprise

auckland.ac.nz/pgdipbioent

Postgraduate Diploma in Forensic Science

auckland.ac.nz/pgdipforensic

Postgraduate Diploma in Mathematical Modelling

auckland.ac.nz/pgdipmathmodel

Postgraduate Diploma in Science

auckland.ac.nz/pgdipsci

Master of Science

auckland.ac.nz/msc

Master of Bioscience Enterprise

auckland.ac.nz/mbioent

Master of Biotechnology

auckland.ac.nz/mbiotech

Master of Chemistry

auckland.ac.nz/mchem

Master of Data Science

auckland.ac.nz/mdatasci

Master of Ecology

auckland.ac.nz/mecology

Master of Engineering Geology

auckland.ac.nz/menggeol

Master of Environmental Management

auckland.ac.nz/menvmgt

Master of Environmental Science

auckland.ac.nz/menvsci

Master of Food Science

auckland.ac.nz/mfoodsci

Master of Information Technology

auckland.ac.nz/minfotech

Master of Marine Conservation

auckland.ac.nz/mmarinecons

Master of Marine Studies

auckland.ac.nz/mmarinest

Master of Mathematical Modelling

auckland.ac.nz/mmathmodel

Master of Organisational Psychology

auckland.ac.nz/morgpsych

Master of Physiotherapy Practice

auckland.ac.nz/mphysioprac

Master of Professional Studies in Data Science / Digital Security / Mathematics Education

auckland.ac.nz/mprofstuds

Master of Speech Language Therapy Practice

auckland.ac.nz/msltprac

Master of Wine Science

auckland.ac.nz/mwinesci

Doctor of Philosophy (PhD)

auckland.ac.nz/phd

a. These subjects are available as areas of PhD study within other subjects in the Faculty of Science or within other faculties at the University. (Please consult a postgraduate adviser about availability.)

b. Offered by the Faculty of Medical and Health Sciences

c. Must be registered NZ optometrists

Choose from
25 subjects to
personalise your
degree

Find out more
science.auckland.ac.nz

“The support I received from lecturers, tutors and UniServices really helped me settle into my new life in New Zealand.”

Namodh Edirisinghe



Sri Lanka
Bachelor of Advanced Science (Honours),
majoring in Computer Science
[Read more auckland.ac.nz/meet-namodh](http://auckland.ac.nz/meet-namodh)



	Bachelors	Honours	BAdvSci(Hons)	PGCert	PGDip	Taught Masters	Research Masters	Doctorate
Anthropological Science	✓							
Applied Mathematics		✓			✓		✓	a
Applied Physics			✓					
Applied Psychology					✓			
Biological Sciences	✓	✓			✓		✓	✓
Biomedical Science	✓	b			b		b	a
Bioscience Enterprise					✓		✓	
Biosecurity and Conservation					✓		✓	a
Biotechnology		✓			✓	✓	✓	
Chemistry	✓	✓	✓		✓	✓	✓	✓
Clinical Exercise Physiology					✓	✓		
Computational Biology			✓					
Computer Science	✓	✓	✓		✓		✓	✓
Data Science	✓			✓		✓		
Digital Security						✓		
Earth Sciences	✓	✓			✓		✓	a
Ecology						✓		
Engineering Geology							✓	
Environmental Management					✓	✓	✓	a
Environmental Physics	✓	✓			✓		✓	a
Environmental Science	✓				✓	✓	✓	✓
Exercise Sciences	✓	✓			✓		✓	✓
Food Science		✓			✓	✓	✓	✓
Food Science and Nutrition	✓							
Forensic Science					✓		✓	✓
Geography	✓	✓			✓		✓	✓
Geographic Information Science	✓							
Geology								✓
Green Chemical Science	✓	✓	✓		✓		✓	a
Information and Technology Management	✓							a
Information Technology				✓		✓		
Logic and Computation	✓	✓			✓		✓	a
Marine Science	✓		✓		✓	✓	✓	✓
Mathematical Modelling				✓	✓	✓		
Mathematics	✓	✓	✓		✓		✓	✓
Mathematics Education						✓		✓
Medical Physics and Imaging Technology		✓						
Medical Statistics					✓	✓		a
Medicinal Chemistry	✓	✓						
Optometry	b				b	c	b	b
Organisational Psychology						✓	✓	
Pharmacology	✓	✓			✓		✓	a
Physics	✓	✓	✓		✓		✓	✓
Physiology	✓	✓			✓		✓	a
Physiotherapy						✓		
Psychology	✓	✓	✓		✓		✓	✓
Quantative Economics	✓							
Speech Language Therapy Practice						✓		
Speech Science					✓		✓	✓
Statistics	✓	✓	✓		✓	✓	✓	✓
Wine Science					✓	✓	✓	a

Global Studies

The Bachelor and Master of Global Studies address the growing need for people who understand current global issues and are prepared to tackle them in our complex and fast-changing world.

The Bachelor of Global Studies is a cross-faculty degree that draws on combined expertise from Arts, Business, Creative Arts and Industries, Engineering, Law and Science.

Interdisciplinary study will expand your mind as you are exposed to new ways of thinking about the world. As you gain competency in another language you'll deepen your understanding of other cultures and perspectives. It will shape you as an informed citizen who can make a difference in our increasingly globalised world.

The University of Auckland introduced a new Master of Global Studies in 2022, enabling students to delve deeper into global issues and industries.

At both undergraduate and postgraduate level, you'll be encouraged to question, adapt and grow, increasing your flexibility and resilience for a wide range of career possibilities both in New Zealand and overseas. These include international organisations in the public or private sectors, international development, the creative sector, local and national government, NGOs and not-for-profits, foreign affairs and diplomacy, the environmental sector, and the international media.

As part of the Global Studies programme, you'll have many opportunities to develop practical employment skills and 'on-the-job' experience through internships, workshops and research projects.

Undergraduate programmes

Bachelor of Global Studies
auckland.ac.nz/bglobalst

Undergraduate majors

- Global Environment and Sustainable Development
- Global Politics and Human Rights
- International Relations and Business
- Transnational Cultures and Creative Practice

Postgraduate programmes

Master of Global Studies
auckland.ac.nz/mglobalstCeaqui autatus

Global Studies research

Dr Jamie Gillen is programme director for Global Studies.

"Our mission is to create the next generation of leaders who are well-placed to shape the intersection of global trends and local issues. Our 'Global' students are part of the most exciting transdisciplinary degree programme at the university, and the first degree of its kind in New Zealand.

"Global Studies is a very new field. We're excited that we have a chance to define it. We look at the students as having a pretty substantial stake in defining this new field through their research at masters level. They will become junior colleagues, as we embark on learning and defining Global Studies."

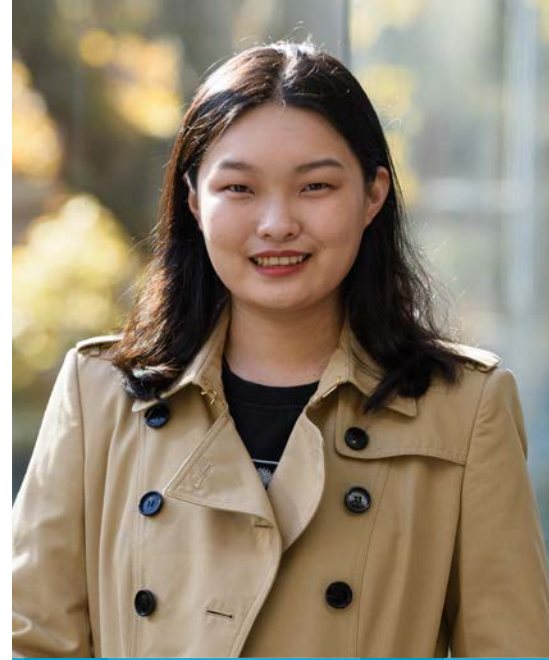

"I came to Auckland because it is New Zealand's most international city, with the best schools. It is culturally diverse, has a wide range of opportunities, and is a very liveable city."

Rachel Ma

Rachel, from China, is studying for a Bachelor of Global Studies / Bachelor of Commerce conjoint degree with a major in International Relations and Business.



Read more
auckland.ac.nz/meet-rachel



**Be different.
Make a difference.
Go global.**

Find out more
auckland.ac.nz/global-studies

International opportunities

Take yourself global

Enhance your skills and employability through these exchanges, short-term programmes, internships, and virtual opportunities.

Be a global learner. 360 International provides University of Auckland students access to a wide range of international learning experiences, both online and overseas. We have active partnerships with many universities and international organisations around the world. Come to the University of Auckland and study in a third country to expand your impact and further your education.

We offer:

- Semester exchange programme
- Virtual programmes
- Short-term opportunities
- Faculty-led programmes
- Student network programmes
- Global internship placements

Find out more:

auckland.ac.nz/360

No.1
Learning
abroad
programme
in New Zealand



Mikaela Phang studied Korean Language Study Abroad at Korea University, and spent two semesters on a 360 International Exchange at Sophia University in Japan.

“Of course you will make friends here at the University of Auckland, but going overseas to study allows you to make similar connections all over the world.”



Study Abroad at the University of Auckland

Spend a summer, a semester or a year at the University of Auckland and earn credits toward your home university qualification.

With 19 of our subjects ranked in the world’s Top 100,* the University of Auckland offers exceptional learning opportunities and the unique experience of living in the urban heart of New Zealand. Explore courses that complement your degree or that immerse you in New Zealand cultural and environmental heritage. You can enrol in up to four courses per semester and choose from over 100 subjects. Popular courses include Māori Studies, Pacific Studies and Environmental/Marine Science.

2024 fee of NZ\$13,200 (approx. US\$8,160) per semester

We offer experiential learning, including student-athlete and research experiences, internships, service learning and community engagement. Extracurricular opportunities are available through our Generation Changemaker Programme, Waipapa Noho Marae and Centre for Innovation and Entrepreneurship. Find out more online.

auckland.ac.nz/studyabroad

Follow our Study Abroad ambassadors on Instagram to find out what it is like to live and study in Auckland.

[instagram.com/studyabroad_auckland](https://www.instagram.com/studyabroad_auckland)

*QS World University Rankings by Subject 2023

Teani DeFries is a Linguistics student at Dartmouth College, USA.

“Engaging with the local people is the best way to truly learn about a culture and the people who live in it day to day. Studying overseas has taught me so much about things that you simply cannot learn in the classroom.”



Pathways to undergraduate study

New Zealand secondary school

International students can study towards New Zealand secondary school qualifications and qualify for entry to university. New Zealand schools have an excellent reputation for their teaching quality and academic facilities. Pastoral care for international students often includes home-stay accommodation with a family.

Most schools offer the National Certificate of Educational Achievement (NCEA), and some offer the internationally recognised University of Cambridge International Examinations (Cambridge International) or International Baccalaureate (IB). The University of Auckland recognises all of these qualifications, which are the same for both New Zealand domestic students and international students. See page 34 for entry requirements.

auckland.ac.nz/is-entry



Vi Nguyen, from Vietnam, completed the Certificate in Foundation Studies at University of Auckland International College. She is in her last year of the Bachelor of Engineering (Honours) in Structural Engineering at the University of Auckland.

"I chose to study the foundation programme to prepare for university and improve my English communication skills. The programme provided excellent academic preparation and built a strong foundation for my first steps in Engineering. I am grateful to my amazing tutors who have helped me academically and ensured my well-being and mental health. This experience has given me the confidence and motivation to pursue my goals and explore new opportunities."

Foundation programmes

If your secondary school qualifications do not meet our entry requirements, a foundation programme can be an alternative entry pathway into a bachelors degree.

Foundation programmes are suitable for both native English speakers and speakers of English as a second language. They will prepare you for university education with skills in:

- Critical and independent thinking
- Computer use and research
- Essential subject knowledge in, for example, accounting, art, biology, calculus, chemistry, classical studies, computer science, design, economics, English, geography, physics and statistics

The University of Auckland offers a choice of foundation programmes taught by two long-standing local partners located close to the University campus in Auckland. As a foundation programme student, you will officially be enrolled at the University of Auckland and have access to the same services as an undergraduate student.

If you complete either of these foundation programmes, you will be guaranteed entry into a University of Auckland bachelors degree programme if you meet the following requirements:

- The minimum overall foundation course average score for your chosen undergraduate degree programme
- English language proficiency at a level equivalent to the International English Language Testing System (IELTS) of at least 6.0 overall, with no band below 5.5, or your foundation course's own minimum English requirement. (Please note that some programmes may require higher scores.)
See page 46 for more information on IELTS equivalent scores.



Chassya, from Indonesia, completed her Foundation Studies Certificate at Taylors College. She is now studying towards a Bachelor of Commerce in Information Systems at the University of Auckland.

"Auckland is really multicultural; the people are nice and so are all the natural views. I love the learning environment at the University, and the lecturers are so helpful. I have learned how to be independent, and Taylors College helped with that. The teaching wasn't just theory, the lecturers also taught us from their own experiences, so they gave us practical knowledge as well. The teachers advised us on the best courses to take at university. I really would love to work in SAP, in information systems."

You must also meet any additional entry requirements for your programme(s) of study, such as an interview, audition or portfolio.

Certificate in Foundation Studies taught by University of Auckland International College

University of Auckland International College
345 Queen Street, Auckland City
Email: admissions@up.education
Phone: +64 9 307 5399
internationalcollege.ac.nz

Foundation Studies Certificate taught by Taylors College

Taylors College
75 Karangahape Road, Auckland City
Email: anziscadmissions@studygroup.com
Phone: +64 9 306 2600
taylorsauckland.ac.nz

University of Auckland International Study Centres

International students outside of New Zealand have the option of completing a foundation programme pathway to the University of Auckland at one of our International Study Centres.

isc.auckland.ac.nz

English Language Academy

If you have not yet met the English language requirements for the University of Auckland, the English Language Academy (ELA) offers programmes that can help you achieve your language goals. The ELA is also an accredited IELTS and PTE Academic testing centre.

Academic pathway programmes

If we have already offered you a place that is conditional on meeting English language requirements, you can fulfil those requirements by successfully completing one of the University of Auckland English Language Academy pathway programmes. If you achieve the required grade, you will meet the University's English language requirements and will not be required to take IELTS or any similar test.

The ELA's English pathway programmes are designed to help you prepare for university studies. The courses cover note-taking, academic report and essay writing, exam preparation, presentation skills and communication techniques.

Our most popular pathway programme is the standard 20-week Foundation Certificate in English for Academic Purposes (FCertEAP). There are also accelerated (10-week) and extended (30-week) options available. The most suitable programme for you will depend on your current level of English. You must have a conditional offer of place and meet the English language entry requirements for your chosen pathway programme.

Full details on the entry requirements for these programmes can be found online.
ela.auckland.ac.nz/course-overview

Other programmes

Academic English will equip you with the skills needed for university studies, including note-taking, academic report and essay writing, exam preparation, presentation skills and communication techniques. This full-time course runs in ten-week blocks. You can choose to focus on either IELTS or university preparation skills. Students can progress from Academic English into FCertEAP.

General English is designed to help you improve your everyday English language skills and is also suitable to prepare you for an Academic English or pathway programme.

English Language Academy

Phone: +64 9 919 7695

Email: ela@auckland.ac.nz

ela.auckland.ac.nz



The ELA pathway programmes

Undergraduate Pathways		
Type	Programme Name	Duration
Accelerated	English Pathway for Undergraduate Studies (EPUS)	10 weeks
Standard	Foundation Certificate in English for Academic Purposes (FCertEAP)	20 weeks
Extended	Foundation Certificate in English for Academic Purposes Plus (FCertEAP Plus)	30 weeks
Postgraduate Pathways		
Type	Programme Name	Duration
Accelerated	English Pathway for Postgraduate Studies (EPPS)	10 weeks
Standard	Foundation Certificate in English for Academic Purposes (FCertEAP)	20 weeks
Extended	Foundation Certificate in English for Academic Purposes Plus (FCertEAP Plus)	30 weeks

Phoebe, from China, completed her Foundation Certificate in English for Academic Purposes (FCertEAP) at the English Language Academy (ELA) and is now pursuing a Master of Commerce (Marketing) at the University of Auckland.

“For me, the most beneficial part of the ELA course was learning not only the use of academic English, but also skills that are relevant to a university course. For example, how to research literature, how to read articles, and how to write a proper academic essay. I think that’s very helpful for the university courses that I’m going to enter. And these are things that you can’t learn in a regular English training institute. In addition, I was able to interact with my teachers and classmates fully in English every day. This gave me a continuous English environment experience and made me increasingly confident in spoken English, which is a shortcoming for many Chinese students.”



PhD study

Pursue your PhD at the University of Auckland and pay the same tuition fees as New Zealand doctoral candidates – just NZ\$7,659.60¹ (in 2023)¹. Join a research-led university with a reputation for academic excellence. Collaborate with world-class researchers, publish in leading academic journals and build the skills you need for a successful future in academia, industry and beyond.

Why choose us for your PhD?

World-class reputation

We are an institution of global standing, ranked among the top 100 in the world and No. 1 in New Zealand.²

Our ratings, and accolades from international organisations, recognise our world-leading status in teaching and learning, innovation, research, international outlook and employment outcomes.

Leading research

We are New Zealand's largest research organisation and have more comprehensive research offerings than any other university.³

We support over 60 research units, centres and institutes and host or co-host four Centres of Research Excellence (CoREs). You'll be able to contribute to a wealth of leading research activities in your field.

We are ranked 10th and 12th globally for our work towards sustainability by two major ranking organisations. We nurture and develop world-changing research.⁴

Dynamic academic community

We have a higher concentration of top-ranked researchers than any other university in New Zealand.⁵ We support more annual graduate student completions than any other university in the country.

Our thriving doctoral community is impactful and international. Our doctoral candidates regularly attend international conferences and, on average, publish three papers during their PhD.



Annual PhD fee:
NZ\$7,659.60¹
less than US\$5k*

Comprehensive support

We support your PhD journey with our outstanding financial, academic, employability and research-focused services and opportunities.

These include:

- Postgraduate Research Student Support (PReSS), an individual fund granted to every doctoral candidate for research-related expenses.
- Access to scholarship opportunities that support the studies of exceptional candidates
- Use of the most extensive university library in New Zealand, staffed by advisers who offer personalised research assistance.
- A comprehensive toolkit of workshops, programmes, development opportunities and online resources to enhance your academic and English-language skills and employability.
- Access to services from the School of Graduate Studies, the International Student Support team, the Postgraduate Students' Association, Libraries and Learning Services, and Career Development and Employability Services.

Family benefits

As a New Zealand PhD candidate, you can pay the same tuition fees as a domestic student and bring your family when you study.

Additionally, your spouse or partner may apply for an open work visa valid for the same duration as your student visa.

Your dependent children may attend a New Zealand state school for the same rates as New Zealand children.⁶

1. The 2024 tuition fee had not been set at the time of publication. To be eligible for the domestic fee, you must reside in New Zealand for the duration of your doctoral programme. However, you may undertake research activities and conferences overseas during your doctoral programme (for a cumulative total of no more than 12 months).

2. QS World University Rankings 2024 and Times Higher Education University Rankings 2023.

Employment opportunities

Finding work during and after your PhD is a key concern for many doctoral candidates. Luckily, when you study in New Zealand as a full-time international PhD candidate, your visa will allow you to work while you study.

Upon completing your PhD, you can apply for a three-year post-study work visa through Immigration New Zealand. This visa allows you to work for any employer in New Zealand.

While on this work visa, you may be eligible to apply for residency under the skilled migrant instructions, provided you meet the points requirement set out by Immigration New Zealand.

immigration.govt.nz

Find a research supervisor

Discover the expansive research throughout our faculties and find a supervisor to match your research focus. You can find information about our research experts and explore their current supervision opportunities using our online database, Discovery Profiles. auckland.ac.nz/findasupervisor

auckland.ac.nz/findasupervisor

How to apply

Visit our website for a step-by-step application guide and other helpful information about our PhD programme.

auckland.ac.nz/applying-for-a-doctorate

3. Performance-Based Research Fund (PBRF) latest report 2018.

4. 12th globally in the THE Impact Rankings 2023 and 10th globally in the QS Sustainability Rankings 2023

5. Schooling is free at state and state-integrated schools, although parents are expected to meet some minor costs, including school books, stationery and uniforms

* Exchange rate, May 2023.

Scholarships and funding

Our University is proud to offer a range of scholarships and financial aid options to help make tertiary education more accessible and affordable for all students, regardless of their economic background. This year we have more than NZ\$15 million in scholarships for international students.

Exclusive scholarships for new international students

We offer generous scholarships to high-achieving new international students who wish to study full-time at undergraduate or postgraduate level. To be eligible, you must have received a conditional offer of admission and be enrolled, or enrolling, full-time in an approved programme. Apply for a scholarship at the same time as your application for admission.

- **University of Auckland India High Achievers Scholarship**
Up to \$20,000 towards tuition fees for new international students from India
- **University of Auckland ASEAN High Achievers Scholarship**
Up to \$10,000 towards tuition fees for new international students from ASEAN countries
- **University of Auckland Vietnam Excellence Scholarship**
Up to \$20,000 towards tuition fees for new international undergraduate and postgraduate students from Vietnam
- **University of Auckland International Student Excellence Scholarship**
Up to \$10,000 for new international students undertaking a postgraduate diploma, taught masters or undergraduate degree (gaining University admission with overseas secondary or post-secondary qualifications)

Would you like us to update you on scholarships and upcoming application dates?



Sign up here and tick “scholarships”. We will be in touch.

[response.auckland.ac.nz/
InternationalRegister](https://response.auckland.ac.nz/InternationalRegister)

Faculty-specific scholarships

Every year, different faculties offer a range of scholarships and awards to students enrolled at all levels of study. Enquire with your faculty about available scholarships and awards or search the University’s scholarships database for up-to-date information.

auckland.ac.nz/scholarships

Country-specific scholarships

We work with many generous external scholarship agencies and government bodies to provide opportunities for international students who meet admission entry criteria. These scholarships include:

- Bahrain Ministry of Education Canadian Student Loans Chilean CONICYT Scholarships China
- Scholarship Council Conacyt (Mexico) COLFUTURO (Colombia)
- Dikti-University of Auckland Scholarship (Indonesia)
- FIDERH (Mexico)
- German Academic Exchange Service (DAAD) Lembaga Pengelola Dana Pendidikan (LPDP, Indonesia)
- Malaysia Jabatan Perkhidmatan Awam (JPA) Scholarship
- Malaysia MARA Scholarship Malaysian Ministry of Education Malaysia Petronas Scholarships Oman Government
- Saudi Arabian Government
- Thai Office of the Civil Service Commission Tonga Government Scholarship
- University of Auckland Commonwealth Scholarship (UK and Canada)
- University of Auckland Fulbright Scholarship (USA)

For other country-specific scholarships, contact the relevant organisation in your country.

Doctoral scholarships

The University awards 200 University of Auckland Doctoral Scholarships to high-achieving doctoral candidates applying for admission to an approved doctoral programme each year. NZ\$28,984.50 in 2023.

Manaaki New Zealand Scholarships

These scholarships are funded through the New Zealand Aid Programme and administered by the Ministry of Foreign Affairs and Trade. The purpose is for candidates from selected Pacific, Asian, African, Caribbean, Latin American and Commonwealth countries to gain knowledge and skills that will assist in the development of their home country.

Over \$15 million
in scholarships available in 2024 for international students

Find out more
auckland.ac.nz/is-scholarships



Entry requirements

We welcome applications from international students with New Zealand or overseas qualifications.

English language proficiency

If you are an international applicant and your first language is not English, you will need to provide evidence of your English language proficiency. You can demonstrate this by achieving the required score in an approved English language test, such as IELTS, or successfully completing an ELA pathway programme.

All test results are valid for two years from the date on the test certificate and all English language requirements must be met within one test certificate.

The table below shows the minimum scores for admission to the University. However, some of our undergraduate and postgraduate programmes have higher requirements.

See more information about undergraduate English-language requirements online.

auckland.ac.nz/ug-english-reqs

See more information about postgraduate English-language requirements online.

auckland.ac.nz/pg-english-reqs

International students at New Zealand secondary schools

To be admitted to the University of Auckland you must achieve the New Zealand University Entrance (UE) standard and meet the entry requirements for the undergraduate programme you wish to pursue.

If you have National Certificate of Educational Achievement (NCEA), University of Cambridge International Examinations (Cambridge International), or International Baccalaureate (IB) qualifications, you will be given a rank score.

The entry requirements for your programme will be expressed as the rank score you need to achieve in NCEA, Cambridge International or IB to guarantee you entry. Applicants with scores below these will still be considered, provided places are available.

Some programmes will also require you to have taken specific subjects and gained minimum credits in those, or have other requirements such as a portfolio, audition or interview.

auckland.ac.nz/entry-requirements

English language requirements

If you are entering the University on the basis of NCEA, Cambridge International (NZ) or IB qualifications, you must meet the New Zealand University Entrance (UE) standard literacy requirements for admission.

International applicants entering the University on the basis of qualifications other than NCEA, Cambridge International or IB taken in New Zealand must meet a specified score in IELTS or an alternative approved English test. Alternatively, they must have completed and passed the Foundation Certificate in English for Academic Purposes (FCertEAP), the English Pathway for Undergraduate Studies (EPUS), the English Pathway for Postgraduate Studies (EPPS), or an approved equivalent.

Some programmes may also require you to demonstrate your proficiency in English at a selection interview.

If you are applying for a Faculty of Education teaching programme, you must achieve an IELTS score of 7.0, in addition to NCEA, Cambridge International or IB requirements.

International students outside New Zealand

If you are an international student, you must meet University Entrance, individual programme and English-language requirements.

Academic entry requirements are based on the grades you achieved in your prior study. Some programmes also require you to have taken specific subjects or to fulfil other requirements such as a portfolio, audition, interview or proven research capability.

2024 Minimum English Language Proficiency Requirements									
	IELTS (Academic)	Internet-based TOEFL (iBT)	C1 Advanced (previously - Cambridge English: Advanced (CAE))	C2 Proficiency (previously - Cambridge English Proficiency (CPE))	Foundation Certificate in English for Academic Purposes (FCertEAP)	Pearson Test of English (PTE) Academic	Michigan English Language Assessment Battery (MELAB)	Trinity College London Integrated Skills in English (ISE)	LanguageCert - International ESOL
Undergraduate	Overall score of 6.0 and no bands below 5.5	Overall score of 80 and a written score of 21	Overall score of 169 and no bands below 162		Grade of C-	Overall score of 50 and no PTE Communicative score below 42	80	ISE II with distinction in all 4 components	C1 Expert (LRWS) with a pass overall and no less than a pass in each skill
Postgraduate	Overall score of 7.0 and no bands below 6.5	Overall score of 90 and a written score of 21	Overall score of 176 and no bands below 169		Grade of B-	Overall score of 58 and no PTE Communicative score below 50	85	ISE III with a pass in all 4 components	C1 Expert (LRWS) with a high pass overall and no less than a pass in each skill OR C2 Mastery with a pass overall and no less than a pass in each skill.

Entry into a bachelors degree

You must meet the equivalent of the New Zealand University Entrance (UE) standard (the minimum standard for admission to New Zealand universities) as well as the entry requirements and undergraduate English language requirements for the programme you wish to pursue. These are listed on our website.

If you have completed a qualification not listed on our website, we will assess your application on its merits.

Entry into a bachelors (honours) degree

You will need to have completed an undergraduate degree from a recognised university, in a related subject area, with the required grade point equivalent (GPE). Exceptions are the BAdvSci(Hons), BE(Hons), BMedImage(Hons), BUrbPlan(Hons) and the LLB(Hons). See our website for more information, including the specific entry requirements for your chosen programme(s).

auckland.ac.nz/programmes

Entry into a postgraduate diploma

Entry requirements vary according to your chosen subject area. You will need to have completed an undergraduate degree from a recognised university, in a related subject area, with the required GPE. Some programmes will require a higher GPE. See our website for more information, including the specific entry requirements for your chosen programme(s).

auckland.ac.nz/programmes

View
our entry
requirements



Find out more
auckland.ac.nz/is-entry



Entry into a masters degree

To enter a 120-point (one-year) masters programme, you must have completed one year of postgraduate study, following an undergraduate degree, in a related subject area at a recognised university, with the required GPE.

The entry requirements for a 180-point or 240-point masters vary according to the subject area of your specialisation. Usually, you must have completed a bachelors degree (or equivalent) in a related subject area at a recognised university, with the required grade point equivalent (GPE).

Entry into a Doctor of Philosophy (PhD)

Entry into a PhD is based on academic merit. You should also possess high-level critical research skills and theoretical understanding.

You must be able to demonstrate an ability to carry out independent research and have already completed a significant research project, dissertation, or thesis, at university.

You will need to have completed a masters-level qualification in a field related to your doctoral studies with the required grade point equivalent (GPE).

Your acceptance is also dependent on the availability of an appropriate supervisor and facilities for your area of study.

The graduate adviser in the faculty or department in which you wish to study will be able to assist you and provide more information.

Prior tertiary study

If you have started or completed tertiary study elsewhere and want to study with us, you can transfer from a New Zealand or overseas tertiary institution to the University of Auckland. Your overseas qualification(s) must be approved for admission, and you must also meet the entry and English-language requirements for your programme. In your Application for Admission, you can apply for credit transfer for tertiary courses completed elsewhere.

Calculating your GPA/GPE

Grades or marks achieved at the University of Auckland are calculated as a Grade Point Average (GPA).

Grades or marks achieved through prior study at other institutions are converted into a Grade Point Equivalent (GPE) at the University of Auckland.

To convert your grades into a GPE, use our GPE Calculator:*

gpecalculator.auckland.ac.nz

**The online calculator provides an indicative guide only and does not guarantee admission to the University.*

Accommodation

Our Accommodation provides a safe, comfortable and supportive environment in quality, fully-catered or self-catered residences. All are within easy walking distance of the City Campus, as well as many of Auckland’s main attractions. Your Accommodation fees cover the cost of utilities such as water, electricity. Residents are also given access to UoA WiFi throughout each residence. Bedding packs are available to purchase.

University residences*

					Age						
Carlaw Park Student Village - Nicholls ¹	✓	✗	✓	✓	18+	Single room Two-bedroom family apartment	Shared Private	\$300 \$540	SC	BBQ, games room, lounge, basketball, study room	15 mins
Carlaw Park Student Village - Stuart McCutcheon House ¹	✓	✗	✓	✓	18+	Single room	Shared	\$310	SC	BBQ, games room, lounge, basketball, study room	15 mins
Te Tirohanga o te Tōangaroa ¹	✓	✗	✗	✓	18+	Single room	Shared	\$290	SC	SKY TV lounge, study rooms, games rooms, rooftop deck with BBQ, music room, movie room	5 mins
55 Symonds ¹	✓	✓	✗	✓	18+	Studio Deluxe Studio Deluxe Double	Private Private	\$400 \$415	SC	SKY TV lounge, games room, lounge, BBQ, study room, music room, movie room	8 mins
Waikohanga House ¹	✗	✓	✓	✓	PG	One-bedroom apartment Two-bedroom family apartment Three-bedroom family apartment	Private Private Private	\$455 \$540 \$625	SC	Printing, BBQ, common room	7 mins
Grafton Hall ²	✓	✗	✗	✓	17-19	Single room	Shared	\$455	FC	SKY TV lounge, games room, tennis, study room, music room, BBQ	15–20 mins
Grafton Student Flats ²	✓	✗	✗	✗	17-19	Single Twin-share	Shared	\$305 \$225	SC PC	BBQ, lounge rooms with TV, communal veggie garden	15–20 mins
O’Rorke Hall ²	✓	✗	✗	✓	17-19	Single room Large single room	Shared Shared	\$435 \$460	FC	SKY TV lounge, BBQ, games room, volleyball, study room, music room	5 mins
University Hall Towers ²	✓	✗	✗	✓	17-19	Single room	Shared	\$455	FC	SKY TV lounge, games room, basketball, study room, music room	10 mins
Waipārūrū Hall ²	✓	✗	✗	✓	17-19	Single room Large single room	Shared Private	\$470 \$500	FC	SKY TV lounge, games room, study room, music room, common rooms	10 mins

PG = Postgraduate | FC = Fully catered | SC = Self-catered | PC = Partially catered

Can accommodate single students	Can accommodate couples	Can accommodate small families	Mobility impairment access	Room configurations
Bathroom configurations	2023 residence fees – per week \$NZ*	Catering options	Recreation, sport and academic facilities	Walking distance to City Campus

*All prices quoted are per week and reflect 2023 prices and contract lengths. They are subject to change for 2024. All self-catered residences are available for 42 or 52-week periods, except for Waikohanga House which is only available for a 52-week period.

1. Fees are based on the weekly rates for a 52-week period in 2023.
2. Fees are based on the weekly rates for a 38-week and two nights period in 2023.

Application dates

Applications for Semester One 2024 open on 1 August 2023.

Applications for Semester Two 2024 open on 1 April 2024.

To have the best chance of getting a place in a residence, you should apply for accommodation at the same time you apply for your academic programme. Late applications will be considered if rooms are available.

Couple and family accommodation at the University is limited, especially for those applying outside of the standard academic year.

If you’re applying in Semester Two or between February and November we encourage you to contact our Accommodation team. They will assist you in finding suitable accommodation that best fits your needs.

Contact Accommodation Solutions

Email: accom@auckland.ac.nz



Apply online at
auckland.ac.nz/accommodation



Student services and support

Academic support

Libraries and Learning Services

Libraries and Learning Services provide resources, workshops and advice to help you successfully complete your study.

In addition to the General Library, a number of specialist libraries cover the variety of subjects taught at the University. You can access a diverse collection of electronic resources anytime and from anywhere. Within the libraries, you can access large collections of print, multimedia and microtext materials, including unique manuscript and archive collections.

We offer online and in-person workshops to improve your academic skills, covering topics such as writing skills, referencing, exam preparation, literature searching, presentation skills and thinking critically.

There are more than 4,000 study spaces with easy access to computers, printers, scanners and photocopiers. IC Helpdesks provide IT support for all our students.

library.auckland.ac.nz

English language for university study

The University offers free services to help you improve your English language skills while you study. (For information about English courses to help you meet entry requirements, see page 39.)

Diagnostic English Language Needs Assessment (DELNA)

The DELNA Programme is designed to help students who may need to improve their academic language skills in order to succeed in their studies.

DELNA is a free check of your academic English language skills. Your results will not exclude you from courses you are already enrolled in and will not appear on your official academic record. You will find out more about DELNA during your faculty orientation session.

delna.auckland.ac.nz

English Language Enrichment (ELE) provides on-campus and online opportunities for any student enrolled at the University of Auckland to improve your academic English. At ELE you can get advice about your English, join language-learning groups, participate in Writing in English workshops, and find language exchange partners.

In addition, **ELE Online** provides language-learning materials, including vocabulary, grammar and pronunciation tools to help improve your academic English. Your student online access allows you to use these resources anytime, anywhere.

library.auckland.ac.nz/ele



Academic English Studies

Academic English Studies is taught in the Faculty of Arts. It aims to develop your academic English skills. Contact your Student Centre to find out whether you can credit ACADENG courses to your degree.

arts.auckland.ac.nz/aes

Personal support

Meet and greet

The International Office provides a free airport transfer service for all new international students arriving in Auckland. This is a great way to avoid the stress of finding your own way to your accommodation. We will meet you and give you information to help you settle in to life in Auckland. A web link for this service is included in your Offer of Admission email.

Wellbeing

Be Well offers a range of tools and information to care for your physical, emotional and spiritual wellbeing so you can thrive during your time at University. The team focuses on proactive and preventative measures that promote health, reduce stress and enhance a sense of community and belonging at the University – particularly through events and trainings led by our Student Wellbeing Ambassadors.

auckland.ac.nz/be-well

Inclusive community support

The University is a community of many cultures, identities, ethnicities and diverse values. We offer a welcoming and safe environment for all students, with a range of inclusive support services to fit your unique identities.

auckland.ac.nz/equityhub

Te Papa Manaaki | Campus Care

The Campus Care team works with students to better understand their concerns and needs, streamlining interactions with campus services, and developing a plan that works in the best interests of each individual. Students are assigned a single case manager or mental health case manager (depending on their particular circumstances) who remains in contact and guides them through internal and external services that can support their needs. Students can be referred by others or reach out directly to seek advice.

auckland.ac.nz/campus-care

Orientation

The International Office arranges an Orientation programme for new international students in Semesters One and Two. International Orientation is designed to welcome you and give you all the information you need about the University and living in Auckland. In addition, the University provides Faculty Orientation for all new students and you will also have the opportunity to meet new people and make friends at a range of social and cultural activities.

The Business School provides an Orientation for Business coursework masters students in Quarters Two and Four.

auckland.ac.nz/orientation

UniGuides

UniGuides are current students from the University who can help you find your way around campus and answer your questions during the first few weeks of the semester. You will meet your UniGuide at your Faculty Orientation Day.

auckland.ac.nz/uniGuide

Spirituality

Students of all religious and cultural beliefs are welcome at the University of Auckland, and we offer interdenominational pastoral care and spiritual guidance. Places of worship are available on campus, including a Christian chapel and Muslim prayer rooms, as well as numerous churches, a Hindu temple and a synagogue nearby. Our on-campus groups provide fellowship for students from most major religions.

auckland.ac.nz/spirituality

Career Development and Employability Services (CDES)

Our award-winning Career Development and Employability Services have a designated International Career Development Consultant who is responsible for providing specialised services. These will support your successful transition into work after you have completed your studies. Special events such as careers expos, recruitment events, networking opportunities, workshops and employer presentations can help you to engage with employers and understand the New Zealand job market.

CDES online tools, workshops, events, job board and personalised services can assist you to identify the opportunities available to you. They also provide knowledge, understanding and skills to help you compete in the New Zealand job market.

Go to page 10 to learn more about career development.

cdes.auckland.ac.nz

Childcare

If you need to organise childcare, there are four on-campus early childhood centres, offering places for children aged from three months to five years. Dedicated parent spaces provide facilities for caregivers and children. Childcare services are associated with a cost and are in demand, so apply early.

auckland.ac.nz/parentingsupport

University Health and Counselling Service

University Health and Counselling (UHCS) offers primary health services across multiple campuses. We have experienced doctors, nurses and counsellors trained to help and support you with a range of medical needs. You can enrol to get assistance with physical health (including sexual health), mental health, immunisations and more.

auckland.ac.nz/studenthealth

Fees and charges

All international students are required to have appropriate medical and travel insurance. The University recommends a scheme that meets requirements. (See page 41.) Provided the consultation is for a condition covered by your policy, international students with this scheme will have all University Health and Counselling Service fees charged directly to the insurance company.

auckland.ac.nz/healthandcounselling

Ratonga Hauātanga Tauira | Student Disability Services (SDS)

We welcome international students with disabilities. Student Disability Services has a range of support available, including assessment of support needs, access to disability study spaces and special accommodations for tests and exams. It is important to check that the University is able to meet your specific requirements, as the type and level of support for international students with disabilities may differ from those at your home university. Contact us early so we can discuss your support requirements.

disability.auckland.ac.nz

Personal development

You can complement your academic achievements by getting involved in a number of co-curricular activities that build a range of skills. Two ways to do this are:

Leadership and volunteering

Build up your work and volunteering experience during your time at the University. These roles can be a great way to meet new people, get to know the city, network and develop new skills. Throughout the year, we offer many opportunities to grow your leadership skills and work experience. Become a UniGuide, a Resident Adviser or a Social Media Content Creator, join the AUSA buddy programme, work as part of the UniCrew or Wellbeing Ambassador team, and more. Check out the range of opportunities on offer.

auckland.ac.nz/leadership-and-volunteering

International student support staff

Being away from home is a challenge in itself. To assist you, the University has facilities and extensive support for international students, whatever your background or needs. Our team of international student support staff is available to help you with a range of issues, including immigration, health and wellbeing, financial advice, accommodation and personal support. There is also a 24/7 emergency number available if you urgently need to contact our staff, at any time of the day or night.



[auckland.ac.nz/
international-student-support](http://auckland.ac.nz/international-student-support)



Clubs and societies

Joining a club is a fantastic way to make friends, participate in activities and learn things outside of the lecture theatre, making your student experience richer and more rewarding. Keen on kayaking? Set on sustainability? There are more than 250 clubs on campus – make sure you check them out at the Clubs Expo at the start of each semester.

auckland.ac.nz/clubs

Recreation and sports

The University has recognised the crucial role that sport and recreation play in the wellbeing and success of our students and staff. In semester two of 2024, we will be opening a new Recreation and Wellness Centre, to help maximise students' sporting and fitness opportunities. The new centre will provide greater access to sport and recreation facilities to support a more connected, diverse and balanced student experience.

There is a range of sporting opportunities for students, including social sports leagues, interfaculty and inter-residential tournaments, sports clubs to join, academic and performance support for eligible performance athletes and the opportunity to represent the University at the National Tertiary Championships. Sailing and other marine sports are run from the University's Hyundai Marine Sports Centre. Our new Esports Arena provides an innovative space for community, competition and educational experiences.

If you're looking to keep fit and active, you can find our University Recreation Centre at 70 Stanley Street. Our affordable memberships give you access to a wide range of cardio and strength equipment and multiple studios, where we run group exercise classes and small group programmes – in person and online. The Sports Centre, located at 7 Wynyard Street, provides drop-in sessions for members to take advantage of our indoor courts, with equipment available for rental.

auckland.ac.nz/sportandrec

Cafés, bars and shops

Whether you're lunching with friends or just grabbing a snack, there's an outlet on campus to suit your needs. Our wide range of retailers and vending machines ensure you don't need to travel far, giving you time to enjoy the vibrant campus culture.

auckland.ac.nz/foodandretail



Auckland Advantage™

Auckland Advantage offers support services to help international students achieve their goals, including help with studies, career planning, and preparing for living and studying on campus in Auckland. These services include:

Summer Start International

International students in New Zealand graduating from a New Zealand high school or foundation programme can study at the University of Auckland over the summer to experience life on campus, get a head start on their degree and explore Auckland City.

Career Development and Employability Services (CDES)

Plan and prepare for your future career through our free workshops, events and services at CDES. Our New Zealand Workplace Insights Programme connects you with University alumni from various industries so you can learn what it's like to work in New Zealand.

Centre for Innovation and Entrepreneurship (CIE)

You can access CIE's various programmes, events, workshops, and facilities to develop and nurture an innovative and entrepreneurial mindset. The centre can help you realise your ideas with programmes like Summer Lab and Velocity.

auckland.ac.nz/auckland-advantage



Essential information

Employment

If you are enrolled in a research masters or a doctoral programme you may be eligible for unlimited work rights. Under certain circumstances, other student visa holders may work part-time or full-time (during scheduled University vacations). You should refer to the Immigration New Zealand website for up-to-date information on application procedures for obtaining any variation of the conditions of your student visa.

On completion of your University of Auckland degree, you may apply for a post-study work visa for up to three years. During the period of that work visa, you may be eligible to apply for permanent residency if you meet Immigration New Zealand requirements.

In some departments, masters and PhD students might obtain work as paid teaching assistants in undergraduate teaching courses for approximately 6–10 hours per week. This usually means acting as a laboratory demonstrator or teaching assistant for groups of undergraduate students. Marking duties may also be involved. Activity as a teaching assistant provides valuable professional and teaching experience. For PhD students, we recommend that you work no more than 500 hours per year.

auckland.ac.nz/visa-information

Living costs

Generally you should allow approximately NZ\$26,000–\$35,000 per year (or NZ\$500–\$675 per week) for general living costs, including accommodation, food and transport.

Typical Purchases ¹	
Milk (1 litre)	\$3
Eggs (1 dozen)	\$9–\$11
Bread	\$3–\$7
Big Mac Combo	\$14
Pizza (large)	\$5–\$20
Other costs to consider ¹	
Medical visit	From \$45
Dental visit	From \$70
Haircut	From \$40

¹ Please note, for a private studio apartment, rent could start from \$370 per week.

² These costs are approximate, and are as at May 2023. All prices are quoted in \$NZD. You can convert these prices to your own country's currency on www.xe.com

³ Based on insuring household items

⁴ One-zone return, five days per week AT Hop Card fare



auckland.ac.nz/auckland-living



Student visas

You must apply for a student visa to cover the period you intend to study in New Zealand. You must show evidence you have been accepted into a programme, paid your tuition fees and have sufficient funds to cover your living costs while in New Zealand. You must apply for your student visa before entering New Zealand. Full details on the necessary reporting requirements are available through Immigration New Zealand.

immigration.govt.nz

Eligibility for health services

Most international students are not entitled to publicly-funded health services while in New Zealand. If you receive medical treatment during your visit, you may be liable for the full costs of that treatment if you do not have appropriate insurance. Full details are available through the Ministry of Health.

health.govt.nz

Health and travel insurance

All international students are legally required to have appropriate health and travel insurance. The University has a recommended policy that meets New Zealand government requirements. When you enrol you will automatically be covered by Studentsafe Inbound University, and the insurance premium will be added to your student account. You will receive details with your offer of admission letter from the University.

auckland.ac.nz/is-insurance

Accident insurance

The Accident Compensation Corporation (ACC) provides accident insurance for all New Zealand citizens, residents and temporary visitors to New Zealand, but you may still be liable for other medical and related costs.

acc.co.nz

Approximate weekly living costs 2023 (\$NZ) ¹		
	Fully-catered University residence	Room in a shared private house*
Accommodation	\$435–\$470	\$220–\$350
Electricity	Included in residence fee	\$30–\$50
Internet	Free use of UoA WiFi available in each Hall	\$18
Mobile phone plan	\$15	\$15
Household insurance ²	\$8	\$8
Food	Included in residence fee	\$200
Transport (bus or train from nearby suburbs)	Residences are walking distance from campus	\$24 (\$18 student discount) ³
Entertainment	\$55	\$55
Gym membership	Included in residence fee	\$12
Estimated weekly costs	\$513–548	\$576–\$726

International tuition fees 2024

The University of Auckland calculates fees according to the courses you take within your degree or diploma programme. Fees vary between faculties, and sometimes within a faculty. The tables below give the estimated annual tuition fee based on enrolment in 120 points.

Visit our website for the most accurate and up-to-date information on international tuition fees: auckland.ac.nz/studentfees

You are also required to pay a student services fee. This is calculated on a per point basis. The student services fee for 2024 will be set later in the year. As a guide, the student services fee for 2023 was calculated as NZ\$8.38 per point (GST inclusive).

Expect to pay about NZ\$1,200 per year for books and stationery. Some courses also have fees for field trips or site visits.

Undergraduate programmes (NZ\$)		
Programme	Tuition fee per point	Estimated fees
Bachelor of Advanced Science (Honours)	\$360.36-423.41	NZ\$43,242.90-\$50,809.60
Bachelor of Architectural Studies	\$397.96	NZ\$47,754.80
Bachelor of Arts (except performance and science-based courses)	\$306.97	NZ\$36,836.30
Bachelor of Arts (performance and science-based courses)	\$360.36	NZ\$43,242.90
Bachelor of Commerce	\$367.32	NZ\$44,078.10
Bachelor of Communications	\$360.36-367.32	NZ\$44,078.10
Bachelor of Dance Studies	\$360.36	NZ\$43,242.90
Bachelor of Design	\$375.66	NZ\$45,078.80
Bachelor of Education (Teaching)	\$309.04	NZ\$37,084.50
Bachelor of Education (Teaching English to Speakers of Other Languages)	\$309.04	NZ\$37,084.50
Bachelor of Engineering (Honours)	\$442.68	NZ\$53,121.90
Bachelor of Fine Arts	\$343.20	NZ\$41,183.90
Bachelor of Global Studies	\$306.97-397.96	NZ\$36,836.30-\$47,754.80
Bachelor of Health Sciences	\$326.76	NZ\$39,211.30
Bachelor of Laws	\$360.33	NZ\$43,239.20
Bachelor of Medicine and Bachelor of Surgery - Year 2 onwards (for Year 1 see Bachelor of Health Sciences)	\$693.60	NZ\$83,231.70
Bachelor of Medical Imaging (Honours)	\$326.76	NZ\$39,211.30
Bachelor of Music	\$360.36	NZ\$43,242.90
Bachelor of Nursing	\$326.76	NZ\$39,211.30
Bachelor of Optometry	\$360.36-524.44	NZ\$43,242.90-\$62,933.20
Bachelor of Pharmacy	\$421.37	NZ\$50,563.80
Bachelor of Property	\$367.32	NZ\$44,078.10
Bachelor of Science	\$360.36-405.16	NZ\$43,242.90-\$48,618.80
Bachelor of Social Work	\$309.04	NZ\$37,084.50
Bachelor of Sport, Health and Physical Education	\$309.04	NZ\$37,084.50
Bachelor of Urban Planning (Honours)	\$360.36	NZ\$43,242.90
Study Abroad		NZ\$13,200*

Study Abroad programme	
Flat tuition fee 2023 (Includes student services fee)	\$13,200



For information about refund of fees, please see our [Terms and Conditions at auckland.ac.nz/studentfees](https://auckland.ac.nz/studentfees)

Postgraduate programmes (NZ\$)		
Postgraduate course subject	Tuition fee per point	Annual tuition fee based on 120 points
Architecture	NZ\$423.40	NZ\$50,809.60
Arts	NZ\$343.20	NZ\$41,180.10
Arts (performance and science-based courses)	NZ\$403.20	NZ\$48,386.80
Business and Economics (excluding coursework masters)	NZ\$382.40	NZ\$45,883.90
Dance Studies	NZ\$423.40	NZ\$50,809.60
Design	NZ\$423.40	NZ\$50,809.60
Education (excluding GradDipTchg)	NZ\$333.30	NZ\$39,995.10
Engineering	NZ\$423.40	NZ\$50,809.60
Engineering (geothermal energy courses)	NZ\$520.50	NZ\$62,460.50
Fine Arts	NZ\$403.30	NZ\$48,390.60
Law	NZ\$370.80	NZ\$44,502
Medical and Health Sciences	NZ\$421.40 - NZ\$693.60	NZ\$50,563.80 - \$83,232.70
Music	NZ\$360.40	NZ\$43,242.90
Science	NZ\$423.40	NZ\$50,809.60
Teaching (GradDipTchg)*	NZ\$257.70	NZ\$38,655
Urban Design	NZ\$423.40	NZ\$50,809.60
Urban Planning	NZ\$360.40 - NZ\$423.40	NZ\$43,242.90 - \$50,809.60
Urban Planning (Professional)	NZ\$423.40	NZ\$50,809.60

Business coursework masters programmes	Points	Duration	Estimated tuition fees for complete programme (excluding student service fee)*
	Students complete 150 points in the first 12 months		
Applied Finance (MAppFin)	180	15 months	\$68,826.60
Management (MMgt)	180	15 months	\$68,826.60
Professional Accounting (MProfAcctg)	240	18 months	\$91,768.80
Business Analytics (MBusAn)	180	15 Months	\$68,826.60

Doctoral degrees	2023 annual tuition fee (12-month period)
Doctor of Fine Arts	\$50,740.80
Doctor of Education	\$50,740.80
Doctor of Medicine	\$50,740.80
Doctor of Philosophy (PhD) ⁵	\$7,659.60 (2023) ⁶

1. Estimated annual tuition fees are based on a full-time programme of 120 points during the first year of study. Actual fees may vary depending on specific courses enrolled in.
2. Year 2 and onwards (for Year 1 see Bachelor of Health Sciences).
3. Estimated annual tuition fee based on full-time certificate of 60 points.
4. Fees are estimates and are for the complete masters programme, excluding the student services fee.
5. To be eligible for the domestic fee, PhD students must reside in New Zealand for the duration of their doctoral programme. However, students may undertake research activities overseas during their doctoral programme (for a cumulative total of no more than 12 months). Please note: the domestic fee arrangement for international students applies only to Doctor of Philosophy degrees. All other doctorates (e.g., Doctor of Clinical Psychology, Education, Fine Arts, Medicine, Music and Musical Arts) are charged international tuition fees.
6. The 2023 tuition fee is NZ\$7,659.60. The 2024 domestic PhD fee was not set at time of publication.

Dates to remember

Summer School 2024	
Summer School begins	Thursday 4 January
Auckland Anniversary Day	Monday 29 January
Waitangi Day	Tuesday 6 February
Summer School lectures end	Friday 9 February
Summer School study break	Saturday 10 February
Summer School examinations	Monday 12 – Wednesday 14 February
Summer School ends	Wednesday 14 February
Semester One 2024	
Orientation Welcome	In the week beginning 19 February
Semester One begins	Monday 26 February
Good Friday	Friday 29 March
Easter Monday	Monday 1 April
University Holiday (or Easter Tuesday)	Tuesday 2 April
Mid-semester break	Friday 29 March – Friday 12 April
ANZAC Day	Thursday 25 April
Graduation	To be confirmed
Semester One lectures end	Friday 31 May
Mānawa Mai Information Evening	June (to be confirmed)
King's Birthday	Monday 3 June
Semester One study break	Tuesday 4 – Wednesday 5 June
Semester One examinations begin	Thursday 6 June
Semester One examinations end	Monday 24 June
Semester One ends	Monday 24 June
Inter-semester break	Tuesday 25 June – Friday 12 July
Matariki	Friday 28 June
Semester Two 2024	
Orientation Welcome	In the week beginning 8 July
Semester Two begins	Monday 15 July
Mānawa Mai Open Day	August (to be confirmed)
Semester Two mid-semester break	Monday 26 August – Friday 6 September
Graduation	To be confirmed
Semester Two lectures end	Friday 18 October
Semester Two study break	Monday 21 – Wednesday 23 October
Semester Two examinations begin	Thursday 24 October
Labour Day	Monday 28 October
Semester Two examinations end	Monday 11 November
Semester Two ends	Monday 11 November

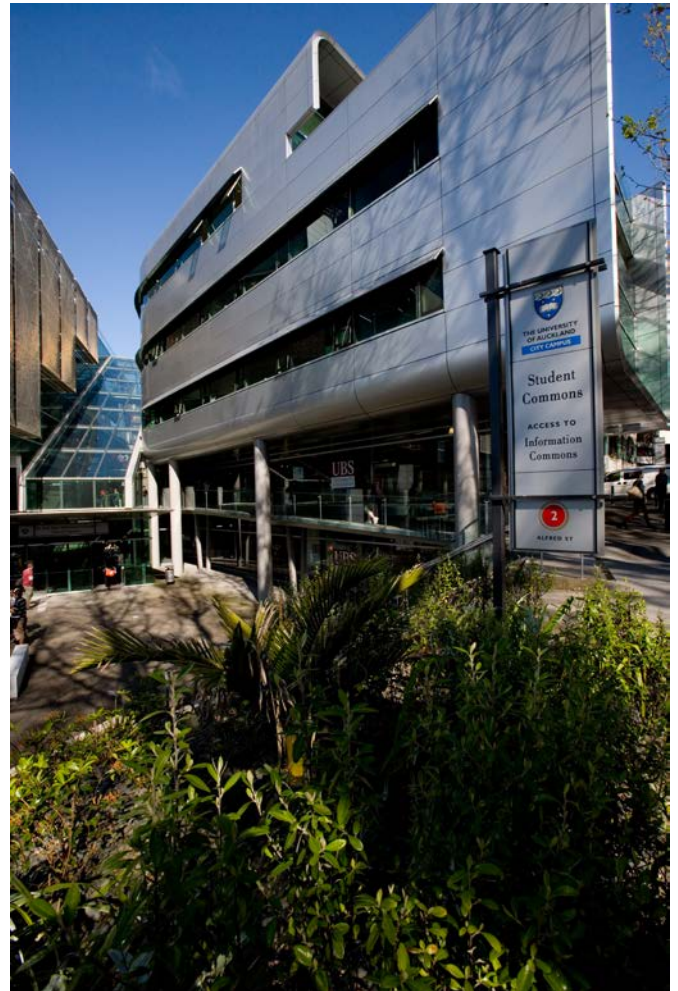

Dates for Business coursework masters

Quarter One 2024	
Lectures begin	Monday 8 January
Lectures end	Friday 15 March
Examinations	Saturday 23 March
Quarter Two 2024	
Lectures begin	Monday 8 April
Lectures end	Friday 14 June
Examinations	Saturday 22 June
Quarter Three 2024	
Lectures begin	Monday 1 July
Lectures end	Friday 6 September
Examinations	Saturday 14 September
Quarter Four 2024	
Lectures begin	Monday 23 September
Lectures end	Friday 29 November
Examinations	Saturday 7 December
Quarter Four ends	Saturday 7 December



Application closing dates

To see the application closing dates for undergraduate programmes, visit auckland.ac.nz/ug-closing-dates

To see the application closing dates for postgraduate programmes, visit auckland.ac.nz/pg-closing-dates

How to apply

For more information on how to apply as an international student, visit:

auckland.ac.nz/international-application

To apply, go to:

applytostudy.auckland.ac.nz

If you have any questions about the application process, please contact the Admissions Office.

Admissions Office

The University of Auckland
Private Bag 92019
Auckland 1142
New Zealand

Questions: auckland.ac.nz/student-hubs

Email: studentinfo@auckland.ac.nz

Phone: 0800 61 62 63

International: +64 9 373 7513

Fax: +64 9 373 7405

Representatives overseas

The University of Auckland has several official representatives in overseas offices. These organisations can give you information about the University of Auckland or help you submit an application. For a complete list of official representatives, please visit: auckland.ac.nz/int-agent-search

The Education (Pastoral Care of Tertiary and International Learners) Code of Practice 2021

The University of Auckland has agreed to observe and be bound by the New Zealand government's Code of Practice for the Pastoral Care of Tertiary and International Learners. Copies of the Code are available in six languages at: nzqa.govt.nz/the-code

iStudent Complaints

istudent.org.nz

Costs

All costs are shown in New Zealand dollars and are expressed inclusive of Goods and Services Tax (GST), if applicable.

Privacy

The University of Auckland undertakes to collect, store, use and disclose information in accordance with the provisions of the Privacy Act 2020. Further details of how the University handles your information are set out in a brochure (*The Privacy Act and You*) available from the Student Hubs or by calling +64 9 373 7513.

Disclaimer

Although we make every reasonable effort to ensure accuracy, the information in this document is provided as a general guide only and is subject to alteration. All students enrolling at the University of Auckland must consult its official document, the current University of Auckland Calendar*, to ensure they are aware of and comply with all regulations, requirements and policies.

Publication date: June 2023.

*Provides information about academic programmes and courses together with academic statutes and regulations governing admission, enrolment, fees and examinations.



Useful web addresses

The University of Auckland homepage

auckland.ac.nz

The University of Auckland Calendar

auckland.ac.nz/calendar

Student Hubs

auckland.ac.nz/student-hubs

Information for international students

auckland.ac.nz/international

University of Auckland representatives overseas

auckland.ac.nz/int-agent-search

Entry requirements

auckland.ac.nz/is-entry

Online application

auckland.ac.nz/international-application

Important dates

auckland.ac.nz/dates

Discover profiles

profiles.auckland.ac.nz

Accommodation

accommodation.ac.nz

Study Abroad and Exchange

auckland.ac.nz/studyabroad

Connect with us:

 facebook.com/UniofAkl

 @universityofauckland

 @universityofauckland

 @AucklandUni

 youtube.com/UniofAuckland



**UNIVERSITY OF
AUCKLAND**
Waipapa Taumata Rau
NEW ZEALAND

Postal address
International Office
The University of Auckland
Private Bag 92019
Auckland 1142
New Zealand

Questions: auckland.ac.nz/student-hubs
Email: studentinfo@auckland.ac.nz
Phone: +64 9 373 7513

International Office
The University of Auckland
Alfred Nathan House
24 Princes Street
Auckland 1010
New Zealand



international.auckland.ac.nz